

BOARD OF COUNTY COMMISSIONERS ● COLUMBIA COUNTY

10

AGENDA ITEM REQUEST FORM

The Board of County Commissioners meets the 1st and 3rd Thursday of each month at 5:30 p.m. in the Columbia County School Board Administrative Complex Auditorium, 372 West Duval Street, Lake City, Florida 32055. All agenda items are due in the Board's office one week prior to the meeting date.

Today's Date: May 5, 2015

Meeting Date: May 21, 2015

Name: Kevin Kirby

Department: Operations

Division Manager's Signature: _____

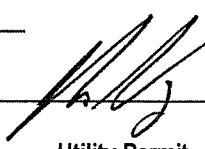

1. Nature and purpose of agenda item: Utility Permit

Attach any correspondence information, documents and forms for action i.e., contract agreements, quotes, memorandums, etc.

2. Fiscal impact on current budget.

Is this a budgeted item?

N/A

Yes Account No. _____

No Please list the proposed budget amendment to fund this request

Budget Amendment Number: _____

FROM

TO

AMOUNT

For Use of County Manger Only:

[] Consent Item

[] Discussion Item

 ORIGINAL

**COLUMBIA COUNTY BOARD OF COUNTY COMISSIONERS
UTILITY PERMIT**

Date: 05/04/2015 Permit No. _____ County Road Ridge Street Section No. _____

Permittee Comcast/ FCCG

Address 731 Duval Station Rd Ste107, Box 402 Jax, Fl 32218 Telephone Number 602-318-5808

Requesting permission from Columbia County, Florida, hereinafter called the County, to contract, operate and maintain Proposed Underground CATV facilities from project start to project finish (see attached plans)

162 SW Ridge Street - Project location

FROM: 05/05/2014 TO: 06/31/2015

Submitted for the Utility Owner by: David McElroy 05/04/2015
Typed Name & Title Signature Date

1. Permittee declares that prior to filing this application it has determined the location of all existing utilities, both aerial and underground and the accurate locations are shown on the plans attached hereto and made a part of this application. Proposed work is within corporate limits of Municipality: YES NO (). IF YES: LAKE CITY FORT WHITE (). A letter of notification was mailed on _____ to the following utility owners _____

2. The Columbia County Public Works Director shall be notified twenty-four (24) hours prior to starting work and again immediately upon completion of work. The Public Works Director is _____, located at _____ Telephone Number _____. The PERMITTEE's employee responsible for Maintenance of Traffic is Robert Francisco Telephone Number 904-380-6425 (This name may be provided at the time of the 24 hour notice to starting work.)

3. This PERMITTEE shall commence actual construction in good faith within 60 days after issuance of permit, and shall be completed within 60 days after permitted work has begun. If the beginning date is more than 60 days from date of permit approval, then PERMITTEE must review the permit with the Columbia County Public Works Director to make sure no changes have occurred in the transportation facility that would affect the permitted construction.

4. The construction and maintenance of such utility shall not interfere with the property and rights of a prior PERMITTEE.

5. It is expressly stipulated that this permit is a license for permissive use only and that the placing of utilities upon public property pursuant to this permit shall not operate to create or vest any property right in said holder.

6. Pursuant to Section 337-403(1), Florida Statutes, whenever necessary for the construction, repair, improvement, maintenance, safe and efficient operation, alteration or relocation of all, or any portion of said transportation facility as determined by the Columbia County Public Works Director and/or County Engineer, any or all utilities and appurtenances authorized hereunder, shall be immediately removed from said transportation facility or reset or

Utilities Permit
Page three
Revised: 8/17/00

Recommended for Approval:

Signature: 

Title: OPERATIONS MANAGER

Date: 05-06-15

Approval by Board of County Commissioners, Columbia County, Florida:

YES () NO ()

Date Approved: _____

Chairman's Signature: _____

Rec'd 5-5-15

relocated thereon as required by the Columbia County Public Works Director and/or County Engineer and at the expense of the PERMITTEE.

7. In case of non-compliance with the County's requirements in effect as of the approval date of this permit, this permit void and the facility will have to be brought into compliance or removed from the right of way at no cost to the County.

8. It is understood and agreed that the rights and privileges herein set out are granted only to the extent of the County's right, title and interest in the land to be entered upon and used by the PERMITTEE, and the PERMITTEE will, at all times, and to the extent permitted by law, assume all risk of and indemnify, defend, and save harmless Columbia County, Florida from any and all loss, damage, cost or expense arising in any manner on account of the exercise or attempted exercise by said PERMITTEE of the aforesaid right and privileges.

9. During construction, all safety regulations of the County shall be observed and the PERMITTEE must take measures, including pacing and the display of safety devices that may be necessary in order to safely conduct the public through the project area in accordance with the Federal Manual on Uniform Traffic Control Devices, as amended for highways.

10. Should the PERMITTEE be desirous of keeping its utilities in place and out of service, the PERMITTEE, by execution of this permit acknowledges its present and continuing ownership of its utilities located between _____ and _____ within the County's right of way as set forth above. PERMITTEE, as its sole expense, shall promptly remove said out of service utilities whenever Columbia County Public Works Director and/or County Engineer determines said removal is in the public interest.

11. Special instructions: Minimum cover of thirty inches (30") will be required at all locations. Columbia County will not be financially responsible for any damage to facilities with less than thirty inches (30") cover. Cables shall not be located within driveway ditches.

12. Additional Stipulations: _____

It is understood and agreed that commencement by the PERMITTEE is acknowledgment and acceptance of the binding nature of these specialist instructions.

Submitted By: David McElroy
Permittee

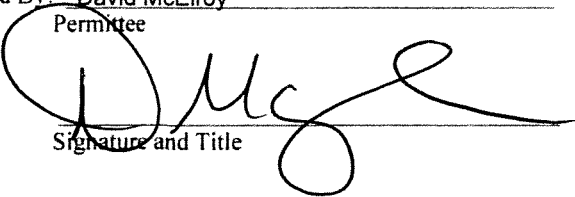

Signature and Title

Place Corporate Seal

Attested

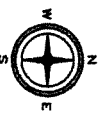

COLUMBIA COUNTY
RIGHT-OF-WAY
PERMIT

RIGHT OF WAY
AERIAL CATV
UNDERGROUND CATV
FIBER
TELEPHONE
GAS
WATER

CONCRETE POLE
WOOD POLE
FIBER POLE
RECREATIONAL
VAULT
ANCHOR

PROPOSED UNDERGROUND CATV / FIBER
FACILITIES IN COLUMBIA COUNTY, FL

DATE	TIME
BY	FOR
SCALE	DATE
PROJECT	PROJECT

JOB SITE:
RIDGE RD
LAKE CITY, FL 32024

JOB NUMBER: 286924

PROJECT TOTALS	
PROPOSED AERIAL CATV / FIBER	0'
PROPOSED UNG CATV / FIBER	238'
TOTAL FOOTAGE	238'
TOTAL PROPOSED BORES	1

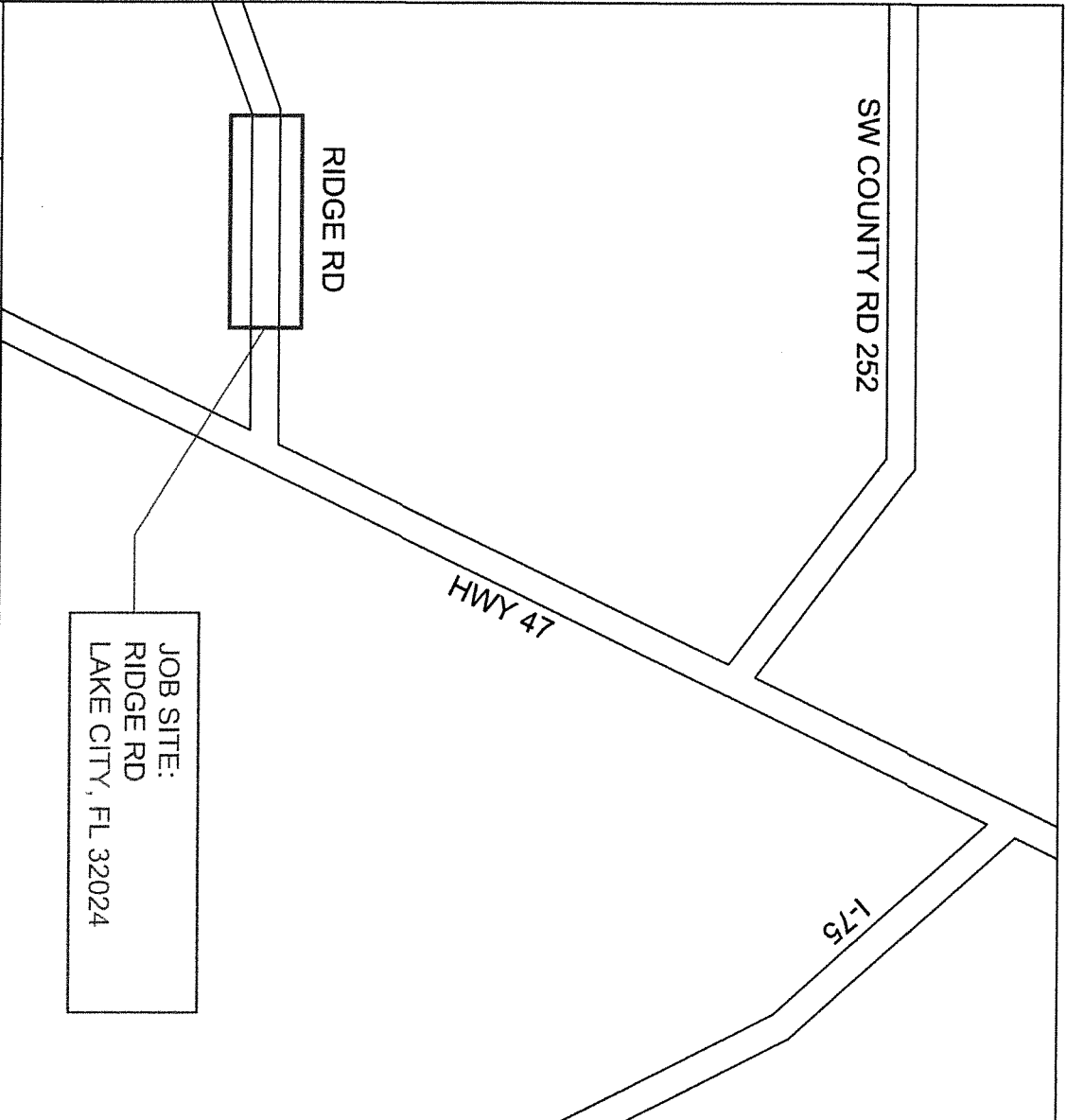
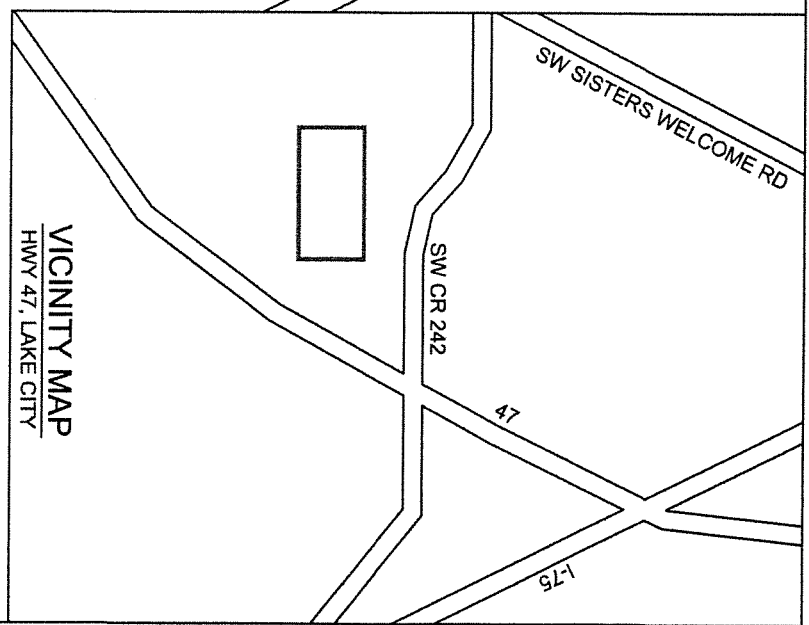

NOTES

- ALL PROPOSED CONSTRUCTION WILL BE PER THE COLUMBIA COUNTY SPECIFICATIONS AS WELL AS ALL NECESSARY SAFETY CODES.
- ALL PROPOSED CATV WILL BE WITHIN THE COLUMBIA COUNTY RIGHT-OF-WAY.
- ALL PROPOSED UNDERGROUND CATV WILL BE BURIED A MINIMUM OF 30" DEEP EXCEPT ROAD BORES 48" DEEP AND DRIVEWAY BORES AT 36" DEEP.
- ALL PROPOSED UNDERGROUND CATV ROAD BORES WILL USE COUNTY APPROVED DIRECTIONAL BORE MACHINE, AS WELL AS COUNTY APPROVED CONDUIT.
- ALL PROPOSED CATV ROAD BORES WILL EXTEND A MINIMUM OF 8' BEYOND THE EDGE OF PAVEMENT.
- ALL PROPOSED CATV DRIVEWAY BORES WILL EXTEND A MINIMUM OF 4' BEYOND THE EDGE OF PAVEMENT.
- ALL PROPOSED BORES WILL BE IN A (4 X 4 X 4) PIT AND WILL USE (2) 2" HDPE CONDUIT AT 48" DEPTH USING A 5 1/4" DRILL HEAD.
- ALL PROPOSED AERIAL WILL BE .700" DIAMETER AND WILL BE LASHED TO .250" STEEL STRAND CABLE USING .125" STANDARD GALVANIZED LASHING WIRE.
- ALL PROPOSED AERIAL CATV CROSSING ROADWAYS WILL HAVE MINIMUM MID-SPAN HEIGHT OF 18'-0"
- ALL PROPOSED AERIAL CATV CROSSING DRIVEWAYS WILL HAVE MINIMUM MID-SPAN HEIGHT OF 16'-0"
- LOCATES WILL BE REQUIRED IN ALL PROPOSED UNDERGROUND AREAS AT LEAST 48 HRS PRIOR TO CONSTRUCTION.
- NOTIFICATIONS TO ALL UTILITIES INVOLVED WILL BE MADE PRIOR TO CONSTRUCTION.

CONSTRUCTION NOTES

IN ORDER TO REDUCE THE DISRUPTION AND COST OF UTILITY DAMAGES OCCURRING IN THE RIGHT-OF-WAY AND EASEMENTS, THE PERMITTEE SHALL PREVENT DAMAGES TO EXISTING UTILITIES CAUSED BY THE WORK THROUGH FIELD VERIFICATION OF THE LOCATION OF THE EXISTING UTILITIES IN CASE OF OPEN EXCAVATION. VERIFICATION MAY BE PERFORMED DURING THE PERMITTEES WORK. IN THE CASE OF DIRECTIONAL DRILLING, VERIFICATION SHALL TAKE PLACE PRIOR TO MOBILIZATION OF THE DRILLING EQUIPMENT.

THE PERMITTEE SHALL VERIFY THE LOCATION OF THE EXISTING UTILITIES AS NEEDED TO AVOID CONTACT WITH DETECTION EQUIPMENT OR OTHER ACCEPTABLE MEANS, SUCH METHODS MAY INCLUDE BUT SHALL NOT BE LIMITED TO "SOFT DIG" EQUIPMENT AND GROUND PENETRATING RADAR (GPR). THE EXCAVATOR SHALL BE HELD LIABLE FOR DAMAGES CAUSED TO CITIES / COUNTIES / STATE INFRASTRUCTURE AND THE EXISTING FACILITIES OF THE OTHER UTILITY COMPANIES

ALL UTILITIES LOCATED BY VISUAL INSPECTION, TO BE VERIFIED BY LOCATES
EOT REPRESENTS EDGE OF TRAVEL NOT TRUE EDGE OF PAVEMENT
E/P REPRESENTS THE TRUE EDGE OF PAVEMENT
EOD REPRESENTS THE EDGE OF DIRT
HAND DIG TRENCHES 36" DEEP ACROSS DIRT ROAD

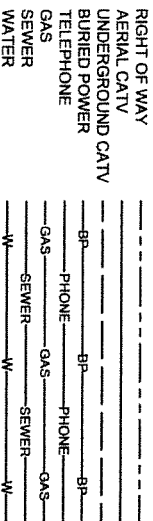

5934 RICHARD ST
JACKSONVILLE, FLORIDA 32216

**COLUMBIA COUNTY
RIGHT-OF-WAY
PERMIT**

RIGHT OF WAY
AERIAL CATV
UNDERGROUND CATV
BURIED POWER
TELEPHONE
GAS
SEWER
WATER

CONCRETE POLE
WOOD POLE
RISER POLE
FIBERSTAL
WALL
ANCHOR

PROPOSED UNDERGROUND CATV / FIBER FACILITIES IN COLUMBIA COUNTY, FL

PROJECT NO.	DATE	SCALE	DATE

SW RIDGE ST, LAKE CITY

241

BEGIN PROJECT
PROPOSED UNDERGROUND
CATV / FIBER FACILITIES
GPS COORDINATES
30.110152
82.662388

PROPOSED 20' FROM EOP
 AT&T 19' FROM EOP
 PROPOSED U/G CATV / FIBER 15' FROM EOP

SW RIDGE ST

PROPOSED ROAD BORE

PROPOSED U/G CATV / FIBER 15' FROM EOP
 CULVERT 9' FROM EOP

BORE PITS 6' FROM EOP (4 X 4 X 4)

BORE PITS 15' FROM EOP (4 X 4 X 4)

PROPOSED DRIVEWAY BORE
 60' RIGHT OF WAY

20' GRASS
 10' LANE
 10' LANE

PROPOSED DRIVEWAY BORE

162

END PROJECT (EXIT R/W)
PROPOSED UNDERGROUND
CATV / FIBER FACILITIES
GPS COORDINATES
30.110039
82.661752

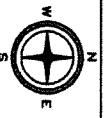
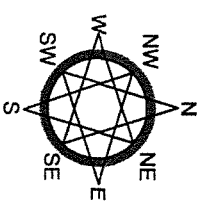

COLUMBIA COUNTY
 RIGHT-OF-WAY
 PERMIT

RIGHT OF WAY	CONCRETE POLE
AERIAL CATV	X WOOD POLE
BURIED POWER	○ RISER POLE
TELEPHONE	□ FIBER TIAL
SWH	□ VALVE
WATER	□ ANCHOR

PROPOSED UNDERGROUND CATV / FIBER FACILITIES IN COLUMBIA COUNTY, FL	
DATE	12/10/2015
TIME	10:00 AM
STATE	FLORIDA
COUNTY	COLUMBIA
CITY	LAKE CITY
PROJECT NO.	15000001
DATE	12/10/2015
TIME	10:00 AM
STATE	FLORIDA
COUNTY	COLUMBIA
CITY	LAKE CITY

**SW RIDGE ST LAKE CITY
CROSS SECTION
FROM TAG "B"
N.T.S**

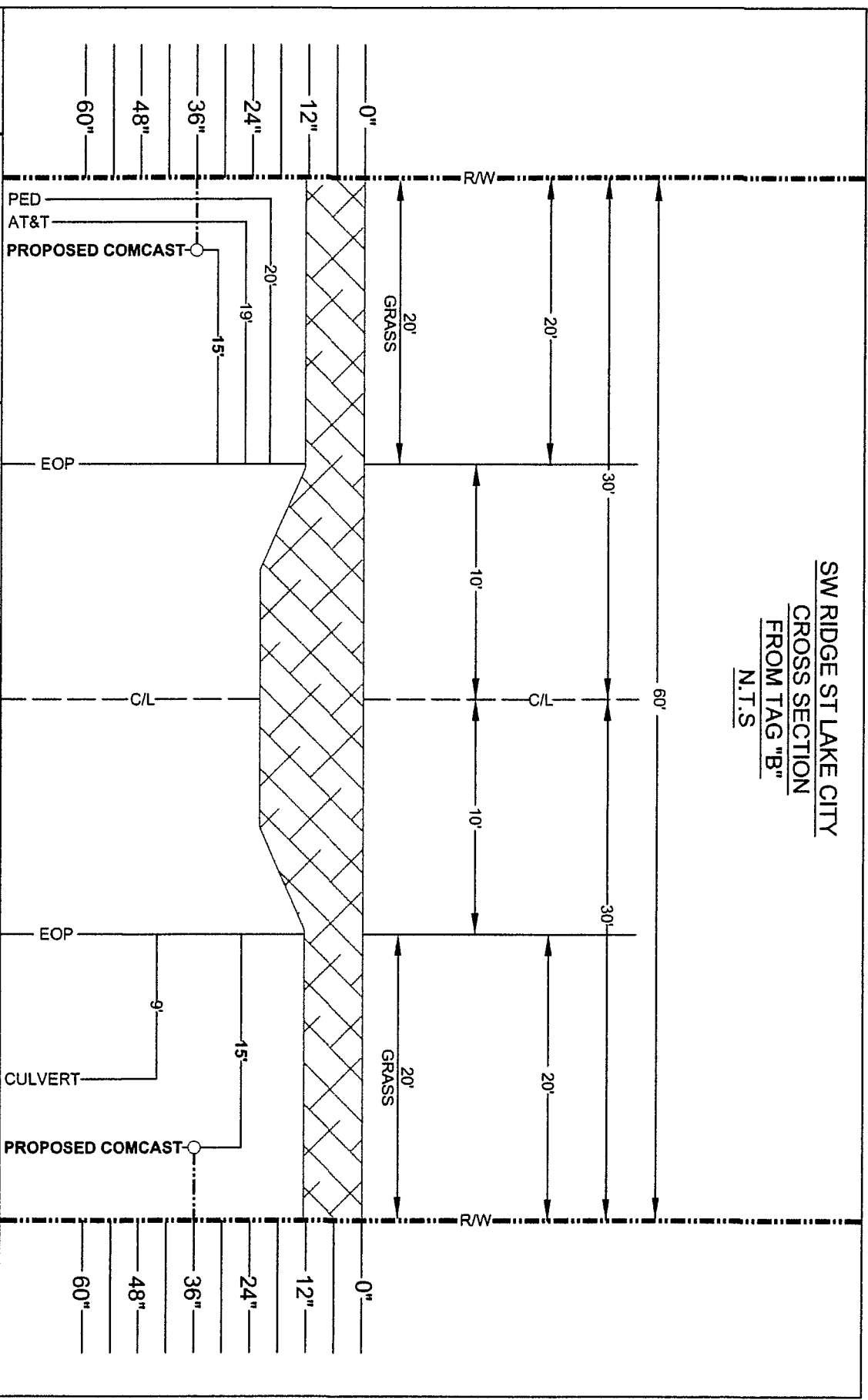

**COLUMBIA COUNTY
RIGHT-OF-WAY
PERMIT**

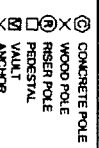
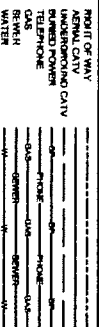

PROPOSED UNDERGROUND CATV / FIBER FACILITIES IN COLUMBIA COUNTY, FL

PROJECT NO.	DATE	SCALE	BY

SW RIDGE ST, LAKE CITY
DRIVEWAY BORE
FROM TAG "C"
N.T.S

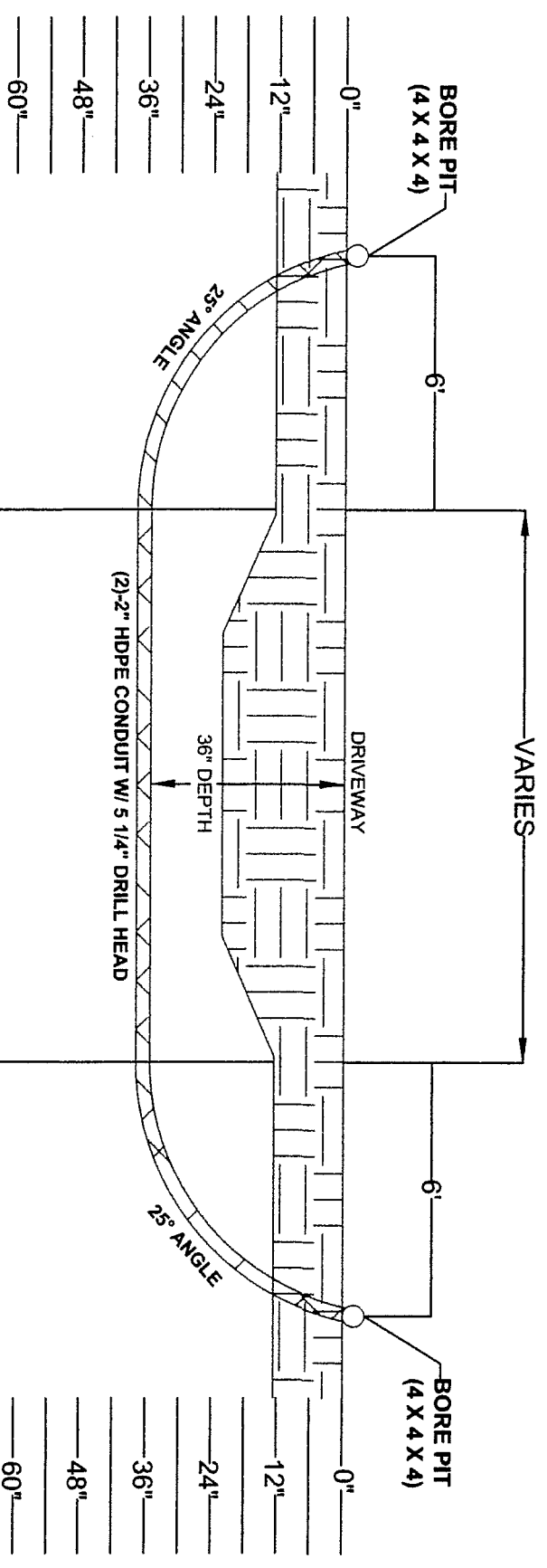

 5924 RICHARD ST
 JACKSONVILLE, FLORIDA 32216

COLUMBIA COUNTY
 RIGHT-OF-WAY
 PERMIT

RIGHT OF WAY
 AIRTEL CATV
 UNDERGROUND CATV
 RISEN POWER
 RISEN FIBER
 GAS
 BR/WR
 WATER

CONCRETE POLE
 WOOD POLE
 RISEN POLE
 PERESTAL
 VAULT
 ANCHOR

PROPOSED UNDERGROUND CATV / FIBER
 FACILITIES IN COLUMBIA COUNTY, FL
 PROJECT NO. 12-0000000000
 SHEET NO. 12-0000000000
 DATE 12-25-12

**RIDGE RD
COUNTY PERMIT
MOT CASES
MID-BLOCK SIDEWALK
CLOSURE**

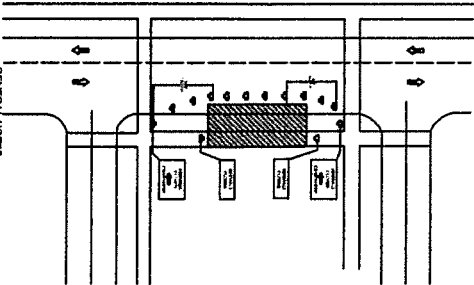

- GENERAL NOTES**
1. ONLY THE SIGNS CONTROL TRAFFIC FLOWS AS SHOWN. OTHER WORK ZONE SIGNS WILL BE NEEDED TO CONTROL TRAFFIC ON STREETS.
 2. TEMPORARY WALKWAYS SHALL BE A MINIMUM OF 4' WIDE AND KEPT FREE OF ANY OBSTRUCTIONS AND HAZARDS SUCH AS HOLES, DEBRIS, AND CONSTRUCTION EQUIPMENT STORED MATERIALS AND ETC. (FOR DETAILS SEE MACH. 180)
 3. POST MOUNTED SIGNS LOCATED NEAR OR ADJACENT TO A SIDEWALK SHALL HAVE A T SIGNAL OR ENRANCE FROM THE BOTTOM OF SIGN TO THE SIDEWALK.
 4. THE STATE OF FLORIDA PRIORITIES AND LOCK CROSSING OF PEDESTRIANS WHEN AN ALTERNATE ROUTE IS NOT FEASIBLE. CONTRACTOR SHALL PROVIDE MAJOR CROSSING PEDESTRIAN PATHWAY THROUGH THE WORK ZONE WHEN SIDEWALK IS CLOSED.
- WORKER SAFETY**
CONTRACTOR SHALL MAINTAIN ALL ACTIVITIES ON THE SIDEWALK FOR A PERIOD OF MORE THAN 90 MINUTES

TWO-LANE, TWO-WAY WORK OUTSIDE SHOULDER

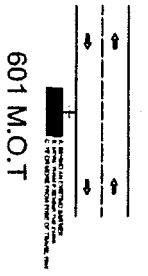

601 M.O.T

MULTILANE WORK OUTSIDE SHOULDER

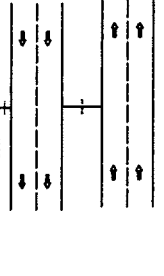

611 M.O.T

**MULTILANE, WORK WITHIN TRAVEL WAY
MEDIAN OR OUTSIDE LANE**

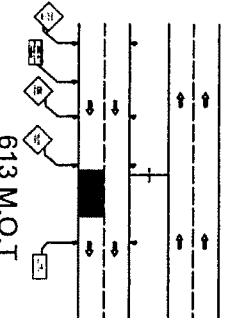

613 M.O.T

WORK IN VICINITY OF RAILROAD CROSSING

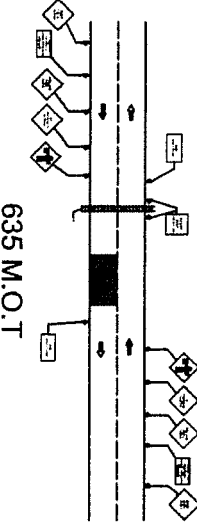

635 M.O.T

TWO-LANE, TWO-WAY WORK ON SHOULDER

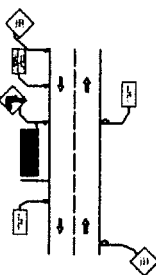

602 M.O.T

MULTILANE, WORK ON SHOULDER

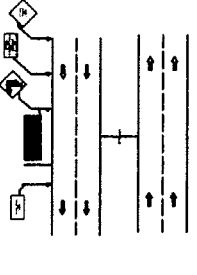

612 M.O.T

TEMPORARY ROAD CLOSURE 5 MINUTES OR LESS

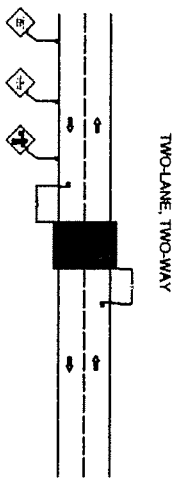

625 M.O.T

TRAFFIC CONTROL NOTES

THE EXISTING PORTED SPEEDS SHALL REMAIN AS SHOWN UNLESS OTHERWISE NOTED. NO SPEED REDUCTION SHALL BE ALLOWED UNLESS PRIOR APPROVAL FROM THE ENGINEER.

ROAD TYPE	10'	15'	20'	25'	30'
URBAN (100 MPH)	10'	15'	20'	25'	30'
URBAN (70 MPH)	10'	15'	20'	25'	30'
URBAN (50 MPH)	10'	15'	20'	25'	30'
URBAN (30 MPH)	10'	15'	20'	25'	30'
URBAN (20 MPH)	10'	15'	20'	25'	30'
URBAN (15 MPH)	10'	15'	20'	25'	30'
URBAN (10 MPH)	10'	15'	20'	25'	30'
URBAN (5 MPH)	10'	15'	20'	25'	30'
URBAN (0 MPH)	10'	15'	20'	25'	30'

MAINTENANCE OF TRAFFIC REQUIREMENTS

1. ANY MODIFICATION OF THE MAINTENANCE OF TRAFFIC PLAN SHALL BE SUBMITTED TO THE COLUMBIA COUNTY TRAFFIC ENGINEER AND APPROVED PRIOR TO CONSTRUCTION.
2. PROJECT WORK HOURS ARE BETWEEN 7:30 AM TO 7:30 PM ON ALL DAYS.
3. CONTRACTOR SHALL MAINTAIN EXISTING SIGNALS. IF SIGNALS ARE TO BE REPLACED, THEY SHALL BE REPLACED WITHIN 10 BUSINESS DAYS OF THE START OF CONSTRUCTION.
4. THIRTY FOOT BARRIERS ARE REQUIRED AT ALL INTERSECTIONS WHERE THE ROADWAY IS CLOSED.
5. ACCESS TO ALL STREETS AND DRIVEWAYS TO BE MAINTAINED AT ALL TIMES.
6. IF SIDEWALKS ARE DESTROYED AND HAVE TO BE REPLACED, HANDICAPPED SIGNAGE TO BE MAINTAINED.
7. THE CONTRACTOR SHALL CONFINER ALL ACTIVE WORK AREAS TO NO MORE THAN ONE BLOCK AT A TIME.
8. THE ROADWAY SHALL BE RESTORED TO AT LEAST A LIMITED TRAFFIC SIGNAL TO MAINTAIN TRAFFIC FLOW THROUGH THE CONSTRUCTION ZONE.
9. DUST CONTROL MEASURES SHALL BE IMPLEMENTED ON ALL UNPAVED SURFACES UNTIL PAVED.
10. WHEN CONSTRUCTION PLANNING IS NOT SHOWN ON PLANS OR CONTRACTOR WANTS TO ALTER THE PLANNING SHOWN, CONTRACTOR SHALL SUBMIT A PROPOSED CONSTRUCTION PLAN TO THE ENGINEER FOR APPROVAL PRIOR TO CONSTRUCTION.
11. CONTRACTOR SHALL NOTIFY TRAFFIC ENGINEER AND ENGINEER AT LEAST 10 BUSINESS DAYS PRIOR TO THE START OF CONSTRUCTION.
12. TRAFFIC SIGNALS, SIGNAL LIGHTS SHALL BE RESTORED TO PROPER OPERATION WITHIN 24 HOURS OF THE COMPLETION OF WORK.



**COLUMBIA COUNTY
RIGHT-OF-WAY
PERMIT**

MODEL OF WAY	CONCRETE POLE
ANNUAL CITY	WOOD POLE
PERMANENT CITY	RIBBED POLE
TELEPHONE	PERESTIAL
ROAD	WALK
WATER	ANCHOR

PROPOSED UNDERGROUND CATV / FIBER FACILITIES IN COLUMBIA COUNTY, FL	
PROJECT NO.	DATE
SCALE	STATE
DESIGNER	APPROVER
DATE	DATE

THE FOLLOWING DESIGN STANDARDS
 ARE IN ACCORDANCE WITH THE
 FLORIDA DEPARTMENT OF TRANSPORTATION
 2015 600 INDEX
 AND APPLY TO SW RIDGE ST LAKE CITY FL.

- DESIGN STANDARD INDEX NO 602 (TWO LANE TWO WAY, WORK ON SHOULDER)

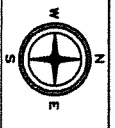

COLUMBIA COUNTY
 RIGHT-OF-WAY
 PERMIT

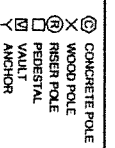
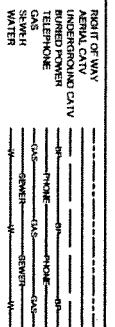

PROPOSED UNDERGROUND CATV / FIBER FACILITIES IN COLUMBIA COUNTY, FL	
PROJECT NO. _____	CITY _____
DATE _____	STATE _____
SCALE _____	TOWN _____
DATE _____	DESIGNER _____

BOARD OF COUNTY COMMISSIONERS ● COLUMBIA COUNTY

11

AGENDA ITEM REQUEST FORM

The Board of County Commissioners meets the 1st and 3rd Thursday of each month at 5:30 p.m. in the Columbia County School Board Administrative Complex Auditorium, 372 West Duval Street, Lake City, Florida 32055. All agenda items are due in the Board's office one week prior to the meeting date.

Today's Date: May 3, 2015

Meeting Date: May 21, 2015

Name: Kevin Kirby

Department: Operations

Division Manager's Signature:  _____

1. Nature and purpose of agenda item: Utility Permit

Attach any correspondence information, documents and forms for action i.e., contract agreements, quotes, memorandums, etc.

2. Fiscal impact on current budget.

- Is this a budgeted item? N/A
- Yes Account No. _____
- No Please list the proposed budget amendment to fund this request

Budget Amendment Number: _____

<u>FROM</u>	<u>TO</u>	<u>AMOUNT</u>
-------------	-----------	---------------

For Use of County Manger Only:

- [] Consent Item [] Discussion Item

**COLUMBIA COUNTY BOARD OF COUNTY COMMISSIONERS
UTILITY PERMIT**

Date: _____ Permit No. _____ County Road Grandview st Section No. _____

Permittee Florida Power & Light Sisters Welcome rd

Address 9001 Ellis Road, Melbourne FL 32904 Telephone Number 321-726-4861

Requesting permission from Columbia County, Florida, hereinafter called the County, to contract, operate and maintain to replace 2 wood poles with 2 new concrete poles and transfer overhead,
WR6095089

3124 SW Grandview st; 1/4 S/O SW Sisters Welcome Rd

FROM: _____ TO: _____

Submitted for the Utility Owner by: Pam Morissette Permit Admin 5/1/15
Typed Name & Title Signature Date

1. Permittee declares that prior to filing this application it has determined the location of all existing utilities, both aerial and underground and the accurate locations are shown on the plans attached hereto and made a part of this application. Proposed work is within corporate limits of Municipality: YES () NO (x). If YES: LAKE CITY () FORT WHITE (). A letter of notification was mailed on _____ to the following utility owners _____ locates will be notified prior to construction

2. The Columbia County Public Works Director shall be notified twenty-four (24) hours prior to starting work and again immediately upon completion of work. The Public Works Director is _____, located at _____ Telephone Number _____. The PERMITTEE's employee responsible for Maintenance of Traffic is _____ Telephone Number _____ (This name may be provided at the time of the 24 hour notice to starting work.)

3. This PERMITTEE shall commence actual construction in good faith within _____ days after issuance of permit, and shall be completed within ¹⁸⁰_____ days after permitted work has begun. If the beginning date is more than 60 days from date of permit approval, then PERMITTEE must review the permit with the Columbia County Public Works Director to make sure no changes have occurred in the transportation facility that would affect the permitted construction.

4. The construction and maintenance of such utility shall not interfere with the property and rights of a prior PERMITTEE.

5. It is expressly stipulated that this permit is a license for permissive use only and that the placing of utilities upon public property pursuant to this permit shall not operate to create or vest any property right in said holder.

6. Pursuant to Section 337-403(1), Florida Statutes, whenever necessary for the construction, repair, improvement, maintenance, safe and efficient operation, alteration or relocation of all, or any portion of said transportation facility as determined by the Columbia County Public Works Director and/or County Engineer, any or all utilities and appurtenances authorized hereunder, shall be immediately removed from said transportation facility or reset or

relocated thereon as required by the Columbia County Public Works Director and/or County Engineer and at the expense of the PERMITTEE.

7. In case of non-compliance with the County's requirements in effect as of the approval date of this permit, this permit void and the facility will have to be brought into compliance or removed from the right of way at no cost to the County.

8. It is understood and agreed that the rights and privileges herein set out are granted only to the extent of the County's right, title and interest in the land to be entered upon and used by the PERMITTEE, and the PERMITTEE will, at all times, and to the extent permitted by law, assume all risk of and indemnify, defend, and save harmless Columbia County, Florida from any and all loss, damage, cost or expense arising in any manner on account of the exercise or attempted exercise by said PERMITTEE of the aforesaid right and privileges.

9. During construction, all safety regulations of the County shall be observed and the PERMITTEE must take measures, including pacing and the display of safety devices that may be necessary in order to safely conduct the public through the project area in accordance with the Federal Manual on Uniform Traffic Control Devices, as amended for highways.

10. Should the PERMITTEE be desirous of keeping its utilities in place and out of service, the PERMITTEE, by execution of this permit acknowledges its present and continuing ownership of its utilities located between SW Grandview St and SW Sisters Welcome rd within the County's right of way as set forth above. PERMITTEE, as its sole expense, shall promptly remove said out of service utilities whenever Columbia County Public Works Director and/or County Engineer determines said removal is in the public interest.

11. Special instructions: Minimum cover of thirty inches (30") will be required at all locations. Columbia County will not be financially responsible for any damage to facilities with less than thirty inches (30") cover. Cables shall not be located within driveway ditches.

12. Additional Stipulations: _____

It is understood and agreed that commencement by the PERMITTEE is acknowledgment and acceptance of the binding nature of these specialist instructions.

Submitted By: Ram Morissette
Permittee

Place Corporate Seal

Ram Morissette 5-17-2015
Signature and Title
Permit Admin

Attested

Utilities Permit
Page three
Revised: 8/17/00

Recommended for Approval:

Signature: _____

Title: Operations Manager

Date: 05-01-15

Approval by Board of County Commissioners, Columbia County, Florida:

YES () NO ()

Date Approved: _____

Chairman's Signature: _____

*Rec'd
5-3-15*

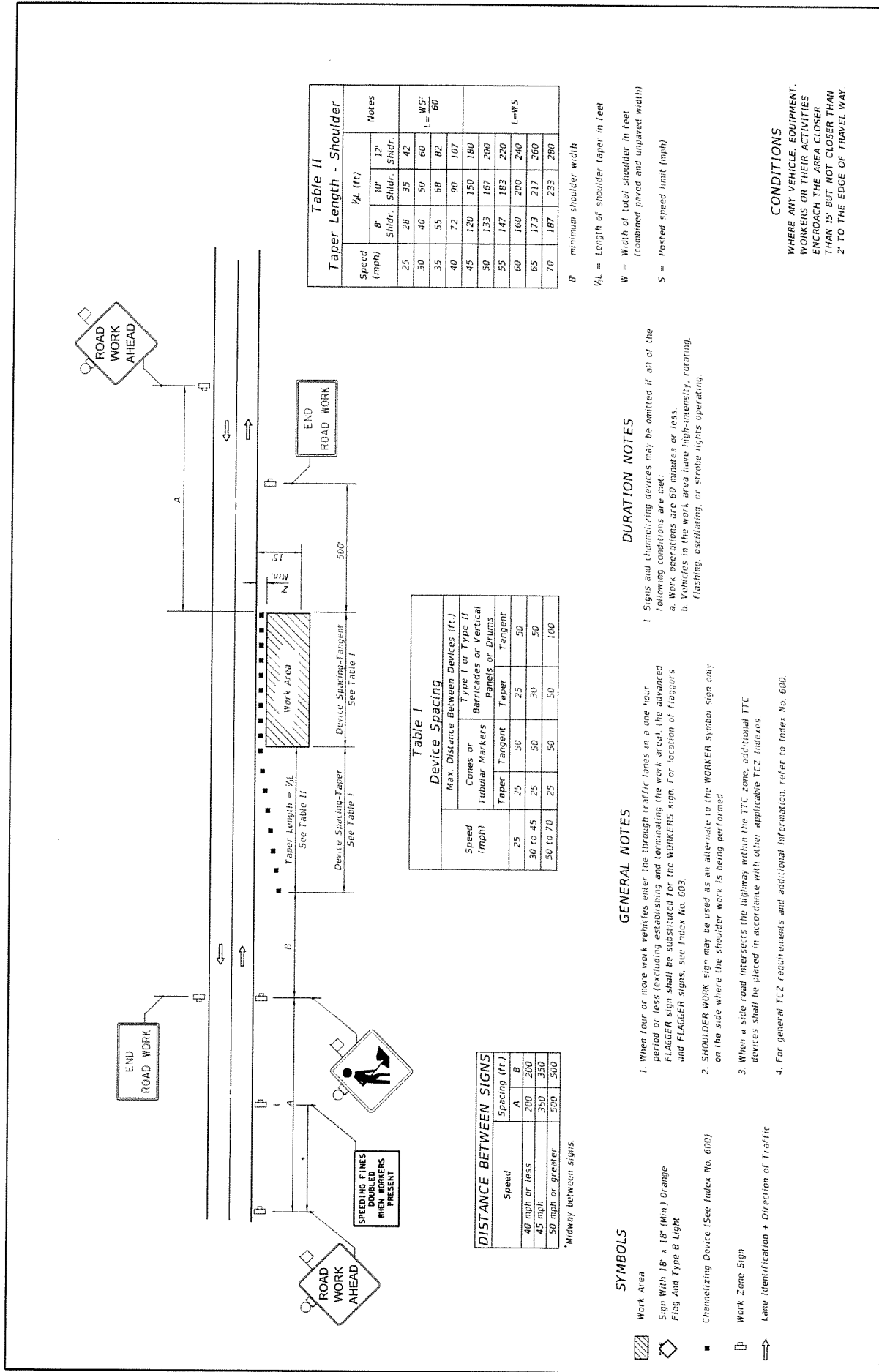

Table II
Taper Length - Shoulder

Speed (mph)	1/2 L (ft)		Notes
	B' Shldr.	12" Shldr.	
25	28	35	42
30	40	50	60
35	55	68	82
40	72	90	107
45	120	150	180
50	133	167	200
55	147	183	220
60	160	200	240
65	173	217	260
70	187	233	280

Table I
Device Spacing

Speed (mph)	Max. Distance Between Devices (ft.)	
	Cones or Tubular Markers	Type I or Type II Barricades or Vertical Panels or Drums
25	25	25
30 to 45	25	30
50 to 70	25	50

DISTANCE BETWEEN SIGNS

Speed	Spacing (ft.)	
	A	B
40 mph or less	200	200
45 mph	350	350
50 mph or greater	500	500

*Midway between signs

SYMBOLS

- Work Area
- Sign With 18" x 18" (Min.) Orange Flag And Type B Light
- Channelizing Device (See Index No. 600)
- Work Zone Sign
- Lane Identification + Direction of Traffic

GENERAL NOTES

- When four or more work vehicles enter the through traffic lanes in a one hour period or less (excluding establishing and terminating the work area), the advanced FLAGGER sign shall be substituted for the WORKERS sign. For location of flaggers and FLAGGER signs, see Index No. 603.
- SHOULDER WORK sign may be used as an alternate to the WORKER sign only on the side where the shoulder work is being performed.
- When a side road intersects the highway within the TTC zone, additional TTC devices shall be placed in accordance with other applicable TTC indexes.
- For general TCZ requirements and additional information, refer to Index No. 600.

DURATION NOTES

- Signs and channelizing devices may be omitted if all of the following conditions are met:
 - Work operations are 60 minutes or less.
 - Vehicles in the work area have high-intensity, rotating, flashing, oscillating, or strobe lights operating.

CONDITIONS
WHERE ANY VEHICLE, EQUIPMENT, WORKERS OR THEIR ACTIVITIES ENCRoACH THE AREA CloSER THAN 15' BUT NOT CloSER THAN 2' TO THE EDGE OF TRAVEL WAY.

LAST REVISION 07/01/12	DESCRIPTION: REVISION	2015 FDOT DESIGN STANDARDS	TWO-LANE, TWO-WAY, WORK ON SHOULDER	INDEX NO. 602	SHEET NO. 1 of 1
---------------------------	--------------------------	-------------------------------	-------------------------------------	------------------	---------------------



IPC	DATE	REVISION
1		
2		
3		
4		



Designer: []	Tras Wood: []	Tras Kocner: []	Tras Shady: []
Checked: []	CTSpecial: []	Wol with SMO: []	Survey: []
POLE LINE FT:	POLE LINE FT ON THRESHOLD POLES:	TRIGGER FT:	POLE LINE FT:
CITY: []	COUNTY AND IN:	STATE AND:	FMA: []
PERMIT REQ'D:	PERM DIST: []	TRASH: []	
Requested Tel. Co. Sht. Transfer: []	Requested Tel. Co. Transfer: []	Requested Cnty. Transfer: []	



Job Owner:	radius
Designer:	Pratikumar Patel
Date:	04/30/2015
Scale: 1" = 125'	
0'	125'
	251'

M/A: NF	Township: 04 Range: 16 Section: 01
AFS150CH - 2015 AFS PLAN - COLUMBIA SUB FEEDER 301136	
INST TWO AFS	
F301136 3 AFS - SW GRANDVIEW ST. LAKE CITY, 32025	Map No: KZ1141
Dwg No: 6095089_11X17 AFS Labels.xml	Page 1 of 6
WR: 6095089	

CALL SUNSHINE #811
48 HOURS BEFORE YOU DIG

LOCATE MARKINGS COLOR CODE

	ELECTRIC		WATER
	GAS-OIL-STEAM		SEWER
	TEMP. SURVEY MARKINGS		CABLE TV
	PROPOSED EXCAVATION		

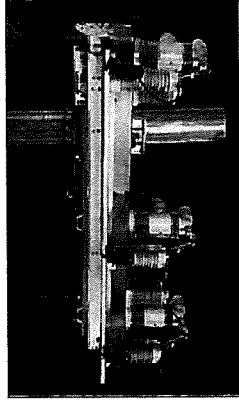

GENERAL NOTES

- NOTIFY CUSTOMERS OF TEMPORARY POWER AND TRAFFIC INTERRUPTIONS.
- PROVIDE WARNING SIGNALS FOR PEDESTRIANS AND TRAFFIC SIGNALS FOR MOTORISTS.
- SERVICE TO TRAFFIC SIGNAL, SCHOOL FLASHING SIGNAL, AND LIGHT STATIONS MUST REMAIN ENERGIZED AT ALL TIMES.

STAKING NOTES

- INTERMEDIATE POLES: STAKE POLES IN-LINE AT STATED DISTANCES.
- POLE REPLACEMENT: STAKE POLES IN-LINE AND WITHIN 2' EITHER SIDE OF EXISTING POLE UNLESS OTHERWISE NOTED.

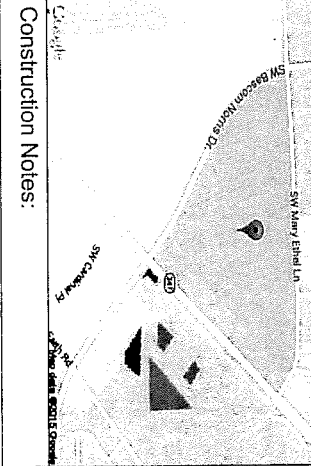

- Construction Notes:**
1. FRAME IN-LINE BY-PASS SWITCHES ON CROSSARM WITH B-PHASE IN ARM POSITION TO MATCH THE SWITCH POLE ARRANGEMENT OF THE I.R. PER DCS C-9.5.0 ATTACHED.
 2. BY-PASS SWITCHES ARE TO BE LOCATED ON SIDE OPPOSITE I.R. INSTALL SWITCHES SO THE BLADES OPEN AWAY FROM THE POLE.
 3. NORMALLY CLOSED INTELLERRUPTER - THE INTELLERRUPTER IS TO BE MOUNTED ON THE SIDE OF THE POLE OPPOSITE THE NORMAL SOURCE (SO THAT THE ISOLATION SWITCHES OPEN AWAY FROM THE SUBSTATION).
 4. NORMALLY OPEN INTELLERRUPTER - THE INTELLERRUPTER IS TO BE MOUNTED ON THE SIDE OF THE POLE TOWARDS THE NORMAL SOURCE OF THE FEEDER.

American Disabilities Act

If pole placement location does not meet the minimum single point distance of 32" from edge of curb or back of sidewalk, contact your Production Lead, for further instructions.

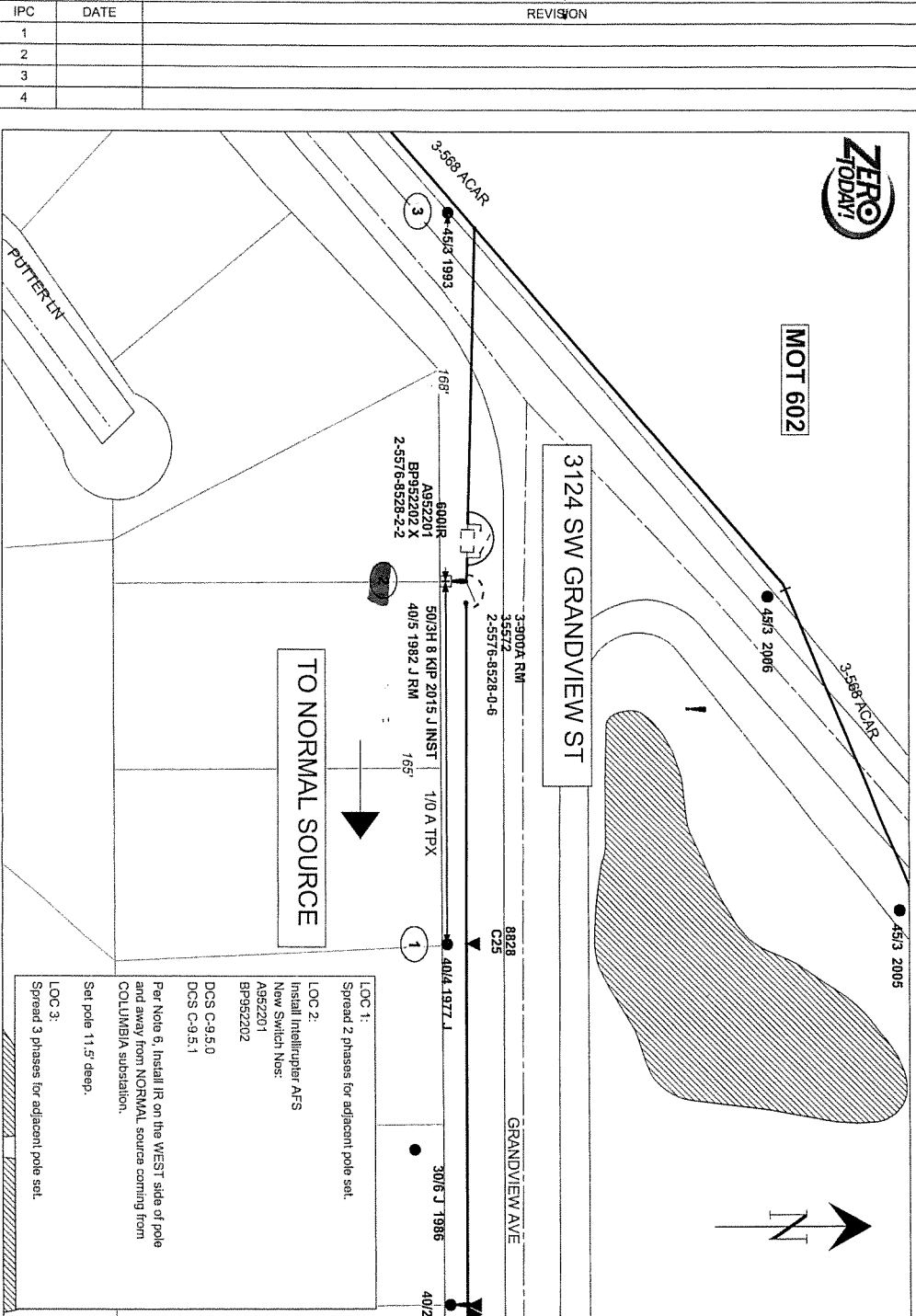

- FEEDERS: COLUMBIA 01136 LIVE OAK 00632
- INACCESSIBLE
 - 13KV
 - FUTURE 28KV
 - 23KV
 - SALT SPRAY
 - ROCK



MOT 602

3124 SW GRANDVIEW ST

TO NORMAL SOURCE

LOC 1:
Spread 2 phases for adjacent pole set.

LOC 2:
Install Inrupter AFS
New Switch Nos:
A952201
BP952202

DCS C-9.5.0
DCS C-9.5.1

Per Note 6, Install IR on the WEST side of pole and away from NORMAL source coming from COLUMBIA substation.

Set pole 11.5' deep.

LOC 3:
Spread 3 phases for adjacent pole set.

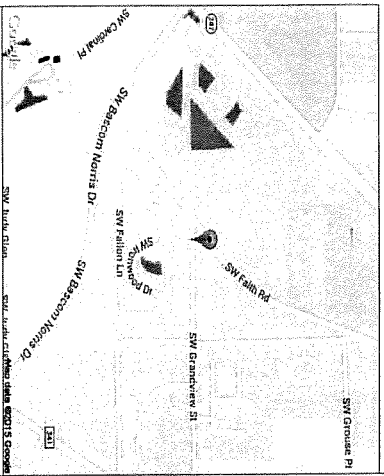

INTELLI RUPTER DATA

Switch #
(Ex: A12345)

Switch Serial #
(Ex: 08-0001234)

Communication Module Serial#
(Ex: 4554-0046-000083)

Control Module Serial#
(Ex: 4554-0046-000083)

Address _____

INTELLI RUPTER CHECKLIST

- Air-Gaps Left Closed
- Battery inside Communication Module Connected
- #4 Cu ground wire connected from back of switch directly to pole ground (not to neutral)
- Arrestor Ground Straps Connected to Switch Arm
- Antenna Installed

Feet of ground rod installed _____

Ground Resistance (Ohms) _____

AS-BUILT CREW PRINT		AS-BUILT COPY	
Forman's Signature	Date	Initials	Cont. Date
Job CERTIFIED COMPLETED as shown on this AS-BUILT print.			
Material changes shown on NCR's.			
Supervisor's Signature	Date		
All required ground rods have been driven & verified to be within 175' attendance. Values are shown at all locations.			
Forman's Signature	Date		
Equipment []	Year Work []	Year Served []	Year Served []
Designer/Sheet []	City Special Mkt []	Work with SMOET []	From Sinking Report []
POLE LINE FT.	POLE LINE FT. ON TRANSFORM. POLES	Survey/Sheet []	Sheet Blank FT.
CITY []	COUNTY RD [X]	COUNTY AIR []	FAA []
WAD []	RR NAME []	CR. DIST. []	TRAVERSE []
Requested Tol. Co. Ser/Printer []	Requested Tol. Co. Transfer []	Requested Tol. Co. Transfer []	
Job Owner: noblix		Pravinkumar Patel	
Date: 04/30/2015		Scale: 1" = 50'	
M/A: NF		Township: 04 Range: 16 Section 01	
AFS/ISCH - 2015 AFS PLAN - COLUMBIA SUB. FEEDER 301136.		INST TWO AFS	
F301136 3 AFS - SW GRANDVIEW ST, LAKE CITY, 32025		Map No. KZ1138	
Dwg No. 6095089_11x17 AFS Latest.xml		Page 2 of 6	
W/R: 6095089			

Replace with concrete pile

overhead work



FEEDERS: COLUMBIA 01131 INACCESSIBLE 13KV FUTURE 23KV 23KV SALT SPRAY ROCK

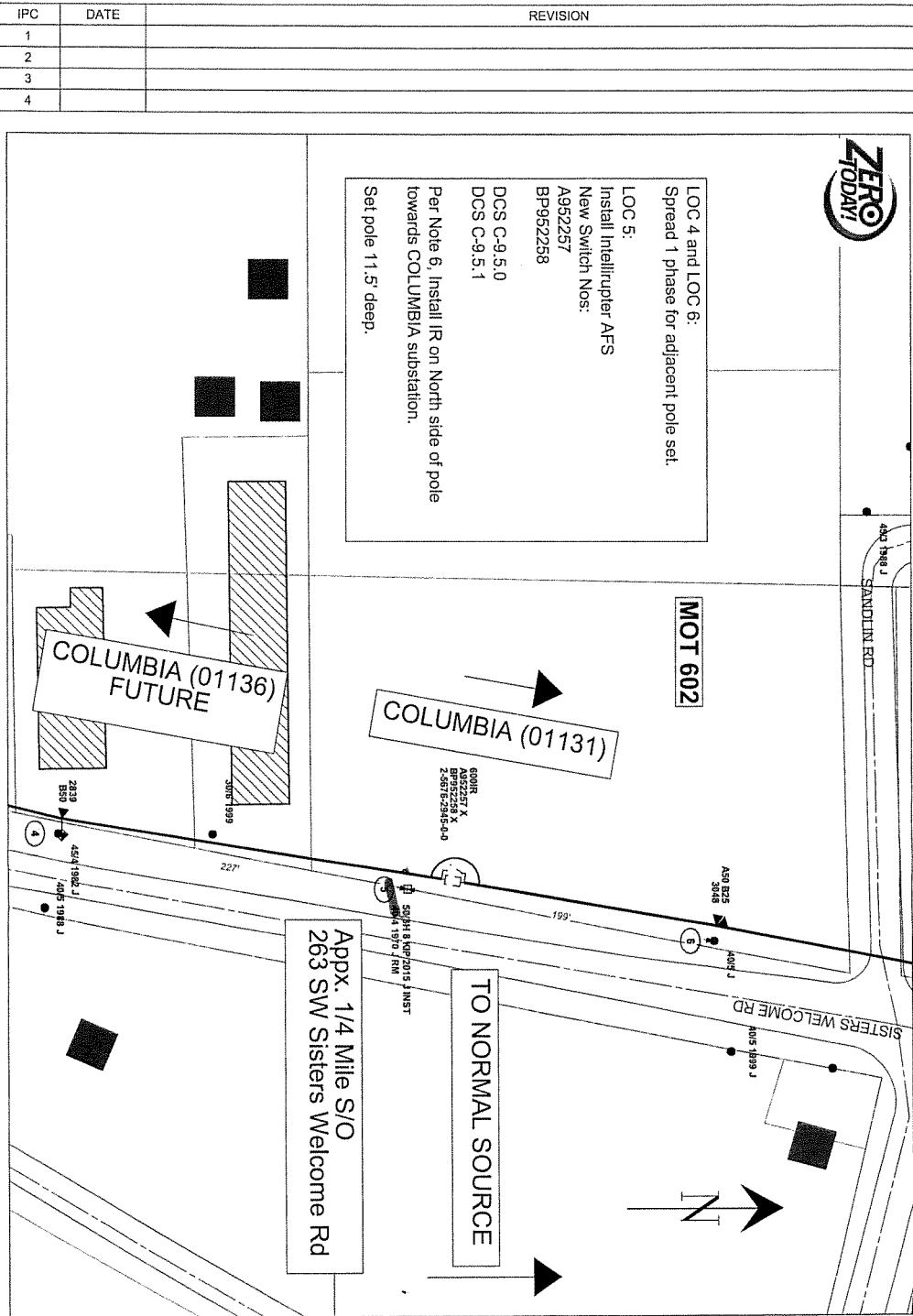

IPC	DATE	REVISION
1		
2		
3		
4		

AS-BUILT DRAW FRONT

Foreman's Signature _____ Date _____

Job CERTIFIED CORP. ETD as shown on this AS-BUILT print. Material changes shown on EDC's.

Supervisor's Signature _____ Date _____

All required ground rods have been driven & verified to be within FPL standards. Material set shown in all drawings.

Foreman's Signature _____ Date _____

Replace w/iron rebars pole

overhead work

Estimated [] New Year? [] Tree Removal []

Designated [] Pole Line FT. ON TRANSFORMER POLES

City [] County RD [] State RD []

Requester Tel. Co. Set Point? [] Requester Tel. Co. Transfer? []

Job Owner: **radiolux**

Designer: **Pravin Kumar Patel**

Date: **04/30/2015**

Scale: 1" = 70'

DWG No. **6095098_11X17_AFS_Label.xml** Map No. **KZ1141**

WR: 6095098 Page 3 of 6

Feet of ground rod installed _____

Ground Resistance (Ohms) _____

- INTELLI-ROUTER CHECKLIST**
- Air-Gaps Left Closed
 - Battery Inside Communication Module Connected
 - #4 Cu ground wire connected from back of switch directly to pole ground (not to neutral)
 - Arrestor Ground Straps Connected to Switch Arm
 - Antenna Installed

INTELLI-ROUTER DATA

Switch # (Ex: A12345) _____

Switch Serial # (Ex: 08-0001234) _____

Communication Module Serial# (Ex: 4534-0046-000083) _____

Control Module Serial# (Ex: 4554-0046-000083) _____

Address _____

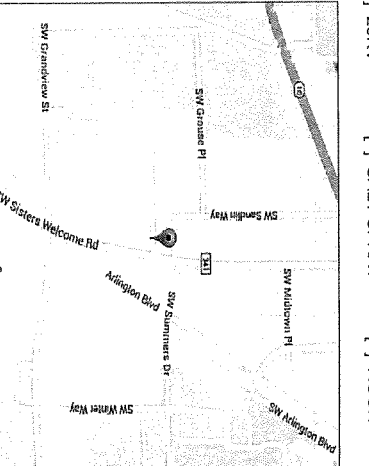

BOARD OF COUNTY COMMISSIONERS ● COLUMBIA COUNTY

12

AGENDA ITEM REQUEST FORM

The Board of County Commissioners meets the 1st and 3rd Thursday of each month at 5:30 p.m. in the Columbia County School Board Administrative Complex Auditorium, 372 West Duval Street, Lake City, Florida 32055. All agenda items are due in the Board's office one week prior to the meeting date.

Today's Date: May 13, 2015

Meeting Date: May 21, 2015

Name: Kevin Kirby

Department: Operations

Division Manager's Signature:  _____

1. Nature and purpose of agenda item: Utility Permit

Attach any correspondence information, documents and forms for action i.e., contract agreements, quotes, memorandums, etc.

2. Fiscal impact on current budget.

- Is this a budgeted item? N/A
- Yes Account No. _____
- No Please list the proposed budget amendment to fund this request

Budget Amendment Number: _____

<u>FROM</u>	<u>TO</u>	<u>AMOUNT</u>
-------------	-----------	---------------

For Use of County Manger Only:

[] Consent Item [] Discussion Item

**COLUMBIA COUNTY BOARD OF COUNTY COMMISSIONERS
UTILITY PERMIT**

(FTWH 704752244)

Date: 5/11/2015 Permit No. _____ Copperhead Ln,
County Road SW Central Terr & SW Utah St Section No. _____

Permittee Windstream Florida, Inc.

ATTN: PERMITS

Address P.O. BOX 698, ALACHUA, FL 32616 Telephone Number 386-462-6521

Requesting permission from Columbia County, Florida, hereinafter called the County, to contract, operate and maintain a fiber optic communications cable placed within the County Right of Way along Copperhead Lane, S/W Central Ter. and S/W Utah St

FROM: Copperhead Lane & S/W Newark Drive TO: S/W Utah & S/W Riverside Ave

Submitted for the Utility Owner by: Douglas M. Pickle - OSP Engr. III *Douglas M. Pickle* 5-11-15
Typed Name & Title Signature Date

1. Permittee declares that prior to filing this application it has determined the location of all existing utilities, both aerial and underground and the accurate locations are show on the plans attached hereto and made a part of this application. Proposed work is within corporate limits of Municipality: YES () NO (x). If YES: LAKE CITY () FORT WHITE (). A letter of notification was mailed on 5-11-15 to the following utility owners
Duke Electric and Progress Energy

2. The Columbia County Public Works Director shall be notified twenty-four (24) hours prior to starting work and again immediately upon completion of work. The Public Works Director is Kevin Kirby, located at Lake City Telephone Number 386-752-5955. The PERMITTEE's employee responsible for Maintenance of Traffic is TRAWICK CONSTRUCTION Telephone Number 866-958-2420 (This name may be provided at the time of the 24 hour notice to starting work.)

3. This PERMITTEE shall commence actual construction in good faith within 60 days after issuance of permit, and shall be completed within 30 days after permitted work has begun. If the beginning date is more than 60 days from date of permit approval, then PERMITTEE must review the permit with the Columbia County Public Works Director to make sure no changes have occurred in the transportation facility that would affect the permitted construction.

4. The construction and maintenance of such utility shall not interfere with the property and rights of a prior PERMITTEE.

5. It is expressly stipulated that this permit is a license for permissive use only and that the placing of utilities upon public property pursuant to this permit shall not operate to create or vest property right in said holder.

6. Pursuant to Section 337.403(1), Florida Statutes, whenever necessary for the construction, repair, improvement, maintenance, safe and efficient operation, alteration or relocation of all, or any portion of said transportation facility

as determined by the Columbia County Public Works Director and/or County Engineer, any or all utilities and appurtenances authorized hereunder, shall be immediately removed from said transportation facility or reset or relocated thereon as required by the Columbia County Public Works Director and/or County Engineer and at the expense of the PERMITTEE.

7. In case of non-compliance with the County's requirements in effect as of the approval date of the permit, this permit is void and the facility will have to be brought into compliance or removed from the right of way at no cost to the County.

8. It is understood and agreed that the rights and privileges herein set out are granted only to the extent of the County's right, title and interest in the land to be entered upon and used by the PERMITTEE, and the PERMITTEE will, at all times, and to the extent permitted by law, assume all risk of and indemnify, defend, and save harmless Columbia County, Florida from any and all loss, damage, cost or expense arising in any manner on account of the exercise or attempted exercise by said PERMITTEE of the aforesaid right and privileges.

9. During construction, all safety regulations of the County shall be observed and the PERMITTEE must take measures, including placing and the display of safety devices that may be necessary in order to safely conduct the public through the project area in accordance with the Federal Manual on Uniform Traffic Control Devices, as amended for highways.

10. Should the PERMITTEE be desirous of keeping its utilities in place and out of service, the PERMITTEE, by execution of this permit acknowledges its present and continuing ownership of its utilities located between Copperhead Lane & S/W Newark Drive and S/W Central Ter. and S/W Utah St within the County's right of way as set forth above. PERMITTEE, at its sole expense, shall promptly remove said out of service utilities whenever Columbia County Public Works Director and/or County Engineer determines said removal is in the public interest.

11. Special instructions: Minimum cover of thirty inches (30") will be required at all locations. Columbia County will not be financially responsible for any damage to facilities with less than thirty inch (30") cover. Cables shall not be located within driveway ditches.

12. Additional Stipulations: _____

It is understood and agreed that commencement by the PERMITTEE is acknowledgment and acceptance of the binding nature of these special instructions.

Submitted By: Windstream Florida, Inc.
Permittee

Place Corporate Seal

Mary D. Cary
Signature and Title

Attested

GARY D. CARY, MANAGER-OSP ENG.

Recommended for Approval:

Signature: _____

Title : _____

Date : _____

Approval by Board of County Commissioners, Columbia County Florida

YES () NO ()

Date Approved: _____

Chairman's Signature: _____

Rec'd 5-13-15



This Drawing and Design are the sole property of Windstream and shall be considered Confidential. This Print may not be reproduced without written consent of Windstream.

CONSTRUCTION DRAWING
 Project: FB FTWH TM 9JK0344B 12343 SW US Hwy 27
 District / Exchange: FORT WHITE, FL
 RTE: 704752244

Drawn by: TMRP	Sheet: 1
Rev: 00	Scale: N/A
RTE: #	Drawing
Sheet	1 of 1

CONTACT NAMES AND NUMBERS:
 Florida OSP Eng. Manager Gary Cary (office) 386-462-6530
 OSP Engineer Mike Pickle (office) 407-835-0341

- Units:**
 BDO - 5
 BDO-CWDM - 1
 BM2 - 6
 BM53F - 6
 BM53FI - 8
 BM60(1)(2)PF<=50 - 40'
 BM60(1)(2)PF>50<=100 - 140'
 BM60(1)(2)PF>200<=500 - 296'
 HAP0(48)3M - 1
 HO1(B)<=12 - 4
 HO1(B)>12<=24 - 48
 BM2C - 1
 WHBFO - 1
 HOMW(B) - 2
 BHF(30x48x36)T - 2
 FHBFOST -

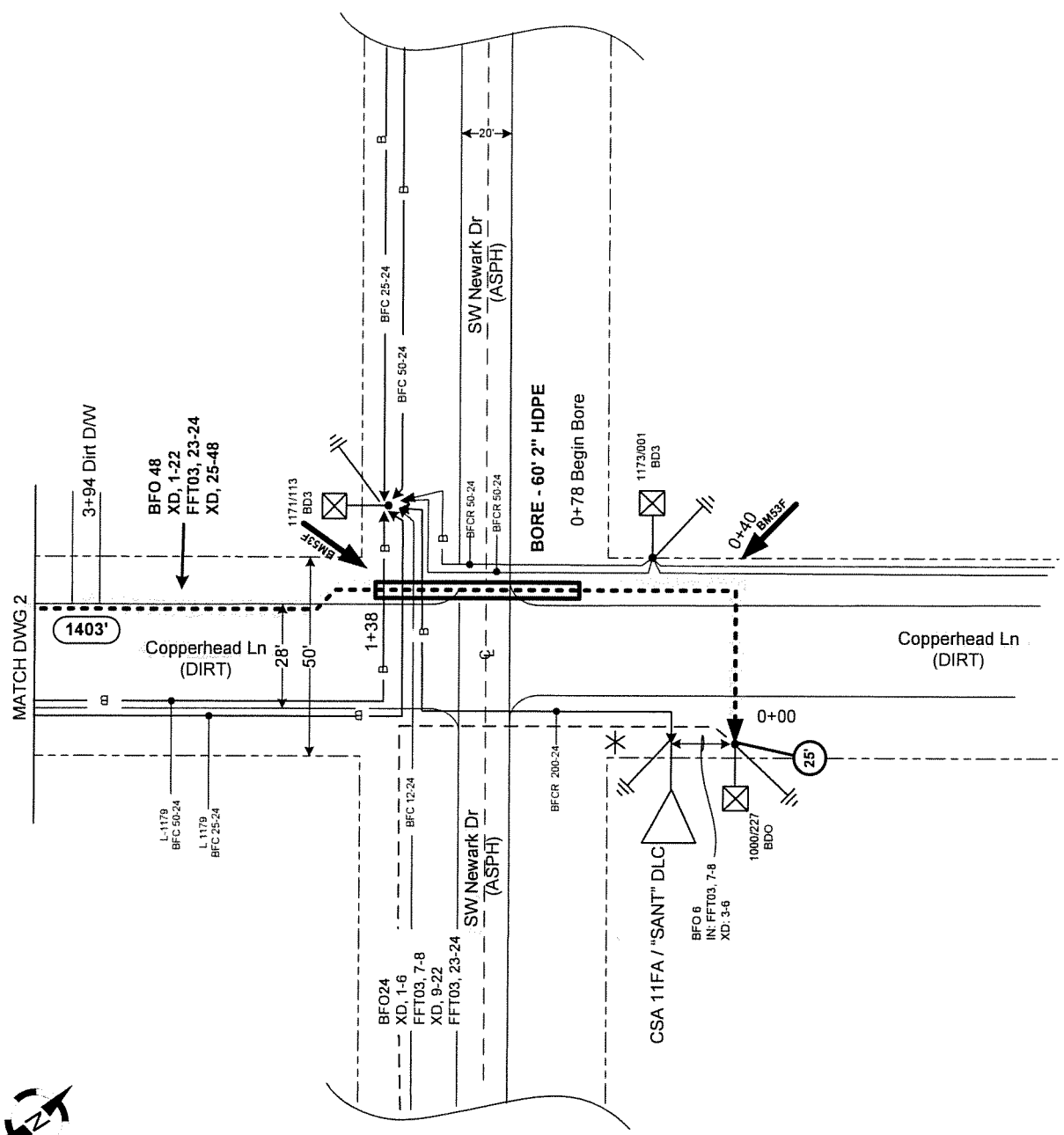



This Drawing and Design are the sole property of Windstream and shall be considered Confidential. This Part may not be reproduced without written consent of Windstream.

CONSTRUCTION DRAWING
 RTE: 704752244
 Project: FB FTVAH TMI 91K0344B 12343 SW US Hwy 27
 District / Exchange: FORT WHITE, FL

Drawings Unit:	
Rev 00	
Scale: NTS	
Sheet	2
Drawing	

CONTACT NAMES AND NUMBERS:
 Florida OSP Eng. Manager: Gary Cary (office) 386-462-6530
 OSP Engineer: Mike Pickle (office) 407-835-0341

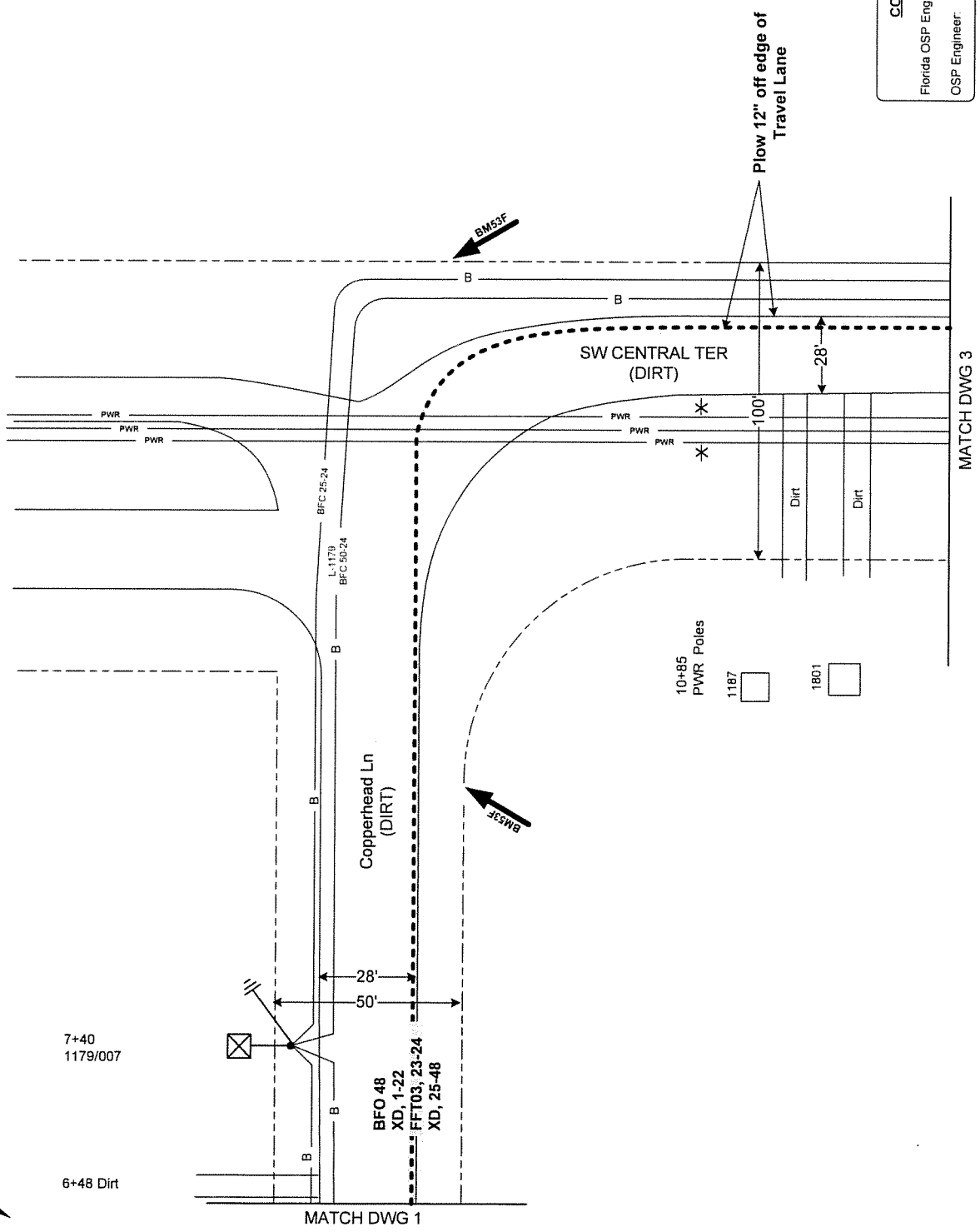

7+40
1179/007

6+48 Dirt

MATCH DWG 1

MATCH DWG 3



This Drawing and Design are the sole property of Windstream and shall be considered Confidential. This Print may not be reproduced without written consent of Windstream.

CONSTRUCTION DRAWING
 RTE: 704752244
 Project: FB FTWH TM 9JN0344B 12343 SW US Hwy 27
 District / Exchange: FORT WHITE, FL

Drawn by: DMH	Sheet: 3
Rev 00	Date: 1/21/25
WTR #	Drawing
Sheet	Total

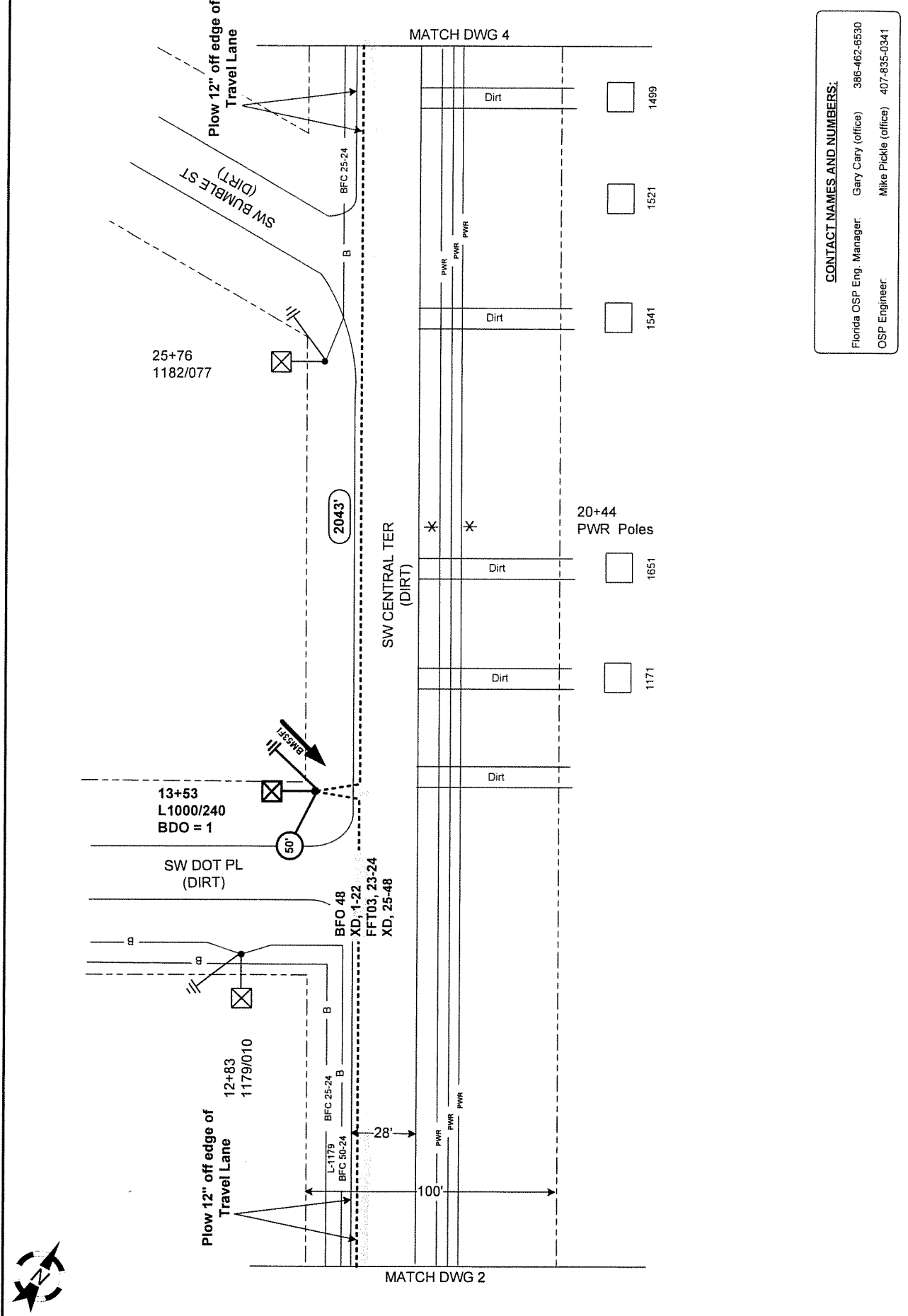

CONTACT NAMES AND NUMBERS:
 Florida OSP Eng. Manager: Gary Cary (office) 386-462-6530
 OSP Engineer: Mike Pickle (office) 407-835-0341





This Drawing and Design are the sole property of Windstream and shall be considered Confidential. This Print may not be reproduced without written consent of Windstream.

CONSTRUCTION DRAWING
 Project: FB FTMH TM 9JK0344B 12343 SW US Hwy 27
 District / Exchange: FORT WHITE, FL
 RTE: 704752244

Drawn by: DMP	Rev: 00
Scale: 1"=100'	Sheet: 4
ECT: *	Drawing
Tot Blk:	

CONTACT NAMES AND NUMBERS:
 Florida OSP Eng. Manager: Gary Cary (office) 386-462-6530
 OSP Engineer: Mike Fickle (office) 407-835-0341

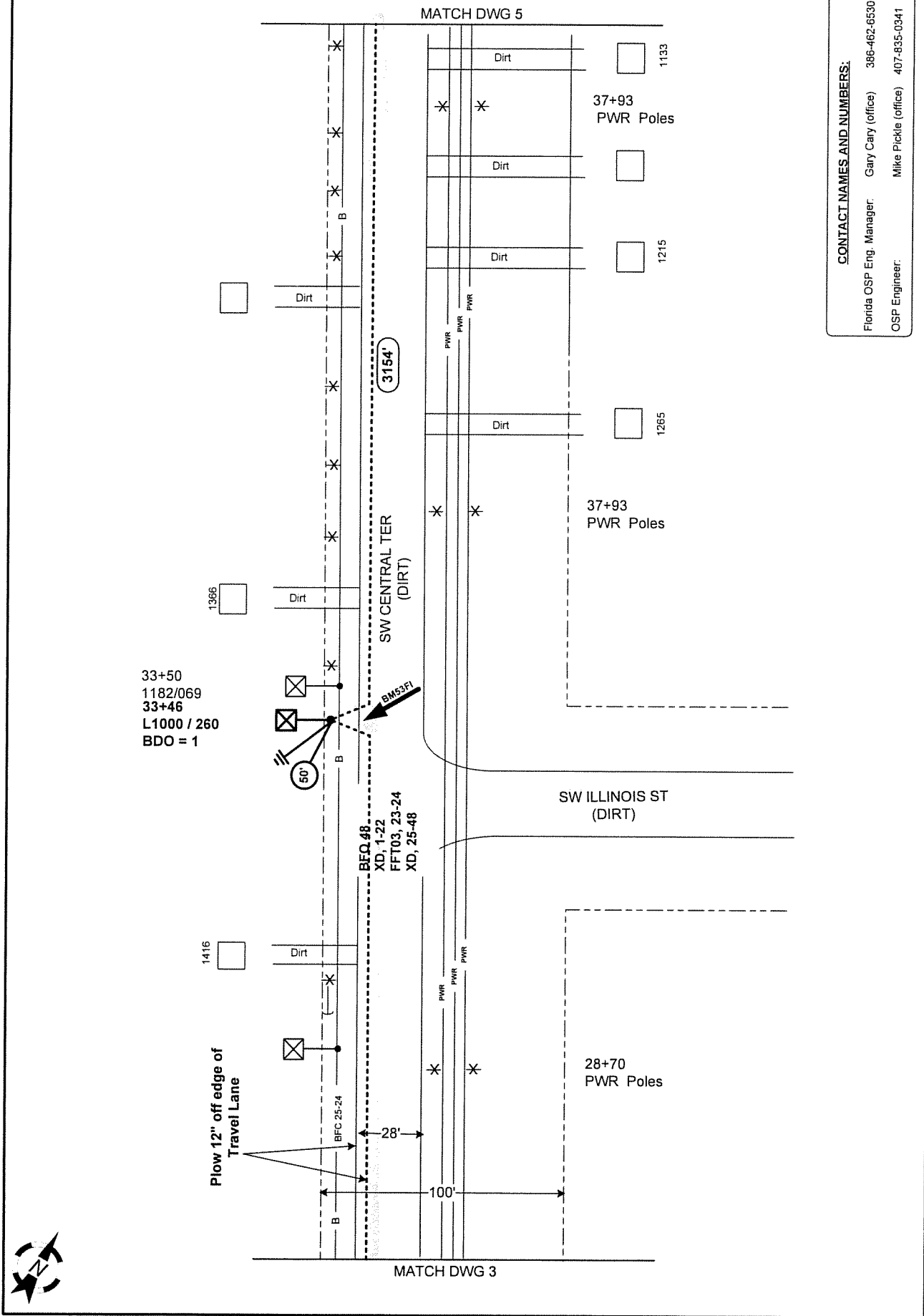



This Drawing and Design are the sole property of Windstream and shall be considered Confidential. This Print may not be reproduced without written consent of Windstream.

CONSTRUCTION DRAWING
 RTE: 704752244
 Project: EB FTWH TM 91K0344B 12343 SW US Hwy 27
 District / Exchange: FORT WHITE, FL

Revised By:	DATE:
Rev 00	
By:	
Scale:	
Sheet:	5
Drawn:	
Checked:	

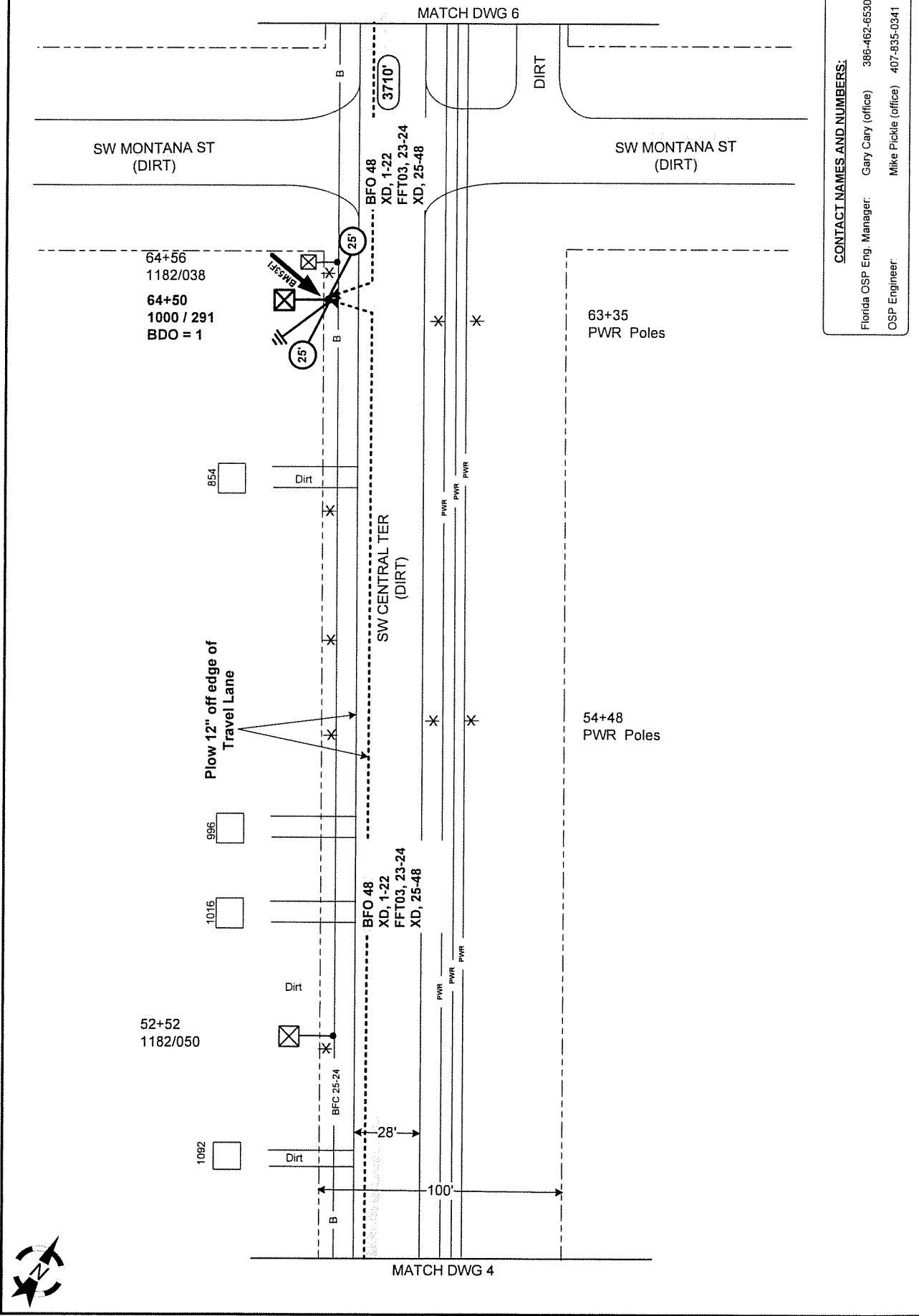

CONTACT NAMES AND NUMBERS:
 Florida OSP Eng. Manager: Gary Cary (office) 386-462-6530
 OSP Engineer: Mike Pickle (office) 407-835-0341





This Drawing and Design are the sole property of Windstream and shall be considered Confidential. This Print may not be reproduced without written consent of Windstream.

CONSTRUCTION DRAWING
 RTE: 704752244
 Project: FB FTWH TM 91K0344B 12343 SW US Hwy 27
 District / Exchange: FORT WHITE, FL

Issued by: IMB/F
Rev 01
Date: 07/15/15
Sheet #
Drawing
Sheet #
Tab Size
6

CONTACT NAMES AND NUMBERS:
 Florida OSP Eng. Manager: Gary Cary (office) 386-462-6530
 OSP Engineer: Mike Pickle (office) 407-895-0341

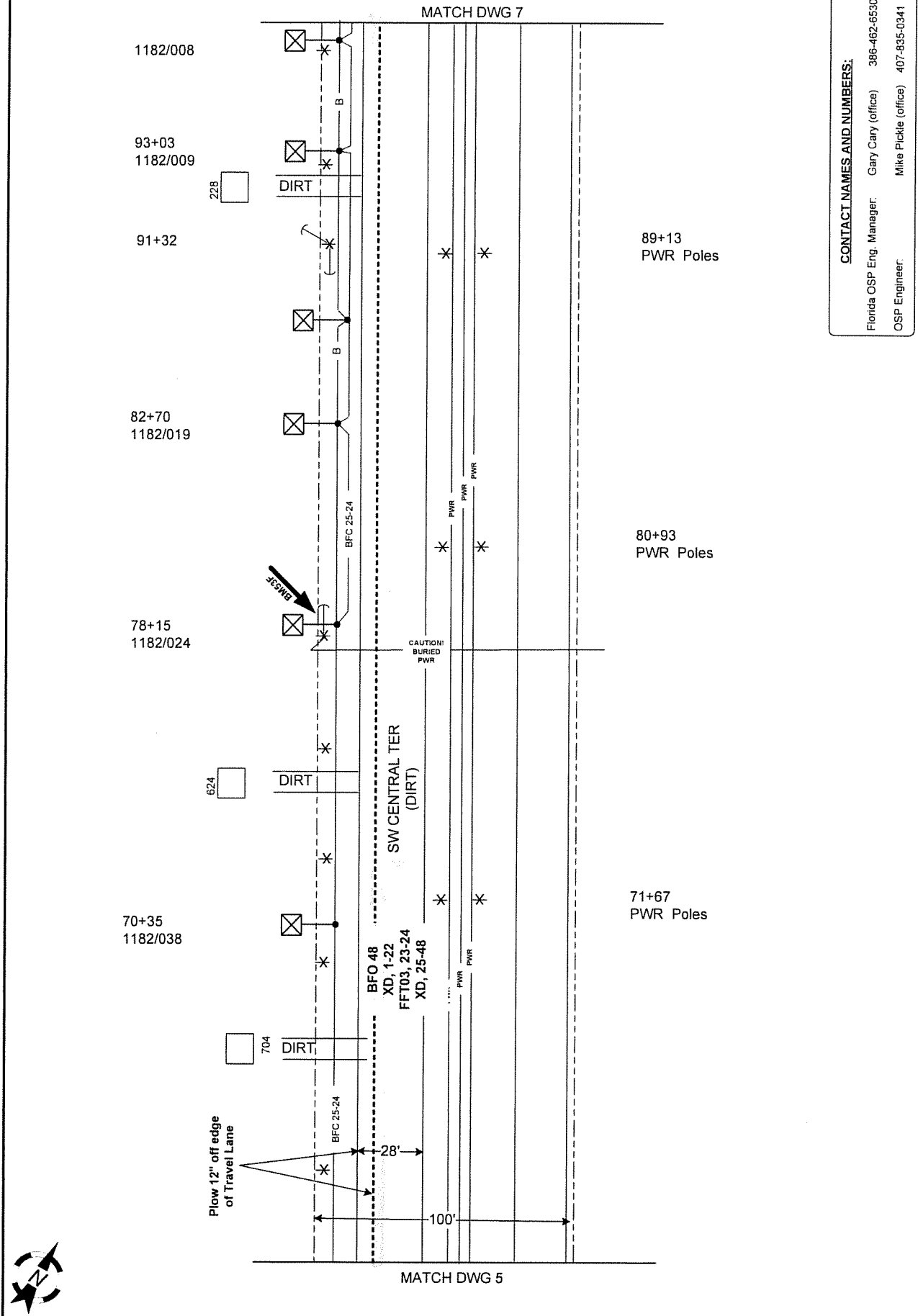



This Drawing and Design are the sole property of Windstream and shall be considered Confidential. This Print may not be reproduced without written consent of Windstream.

CONSTRUCTION DRAWING
 RTE: 704752244
 Project: FB FTWH TM 97K0344B 12343 SW US Hwy 27
 District / Exchange: FORT WHITE, FL

Drawn by: DMH	Rev 00	Scale: N/A	Drawing	Sheet	Total
				7	10

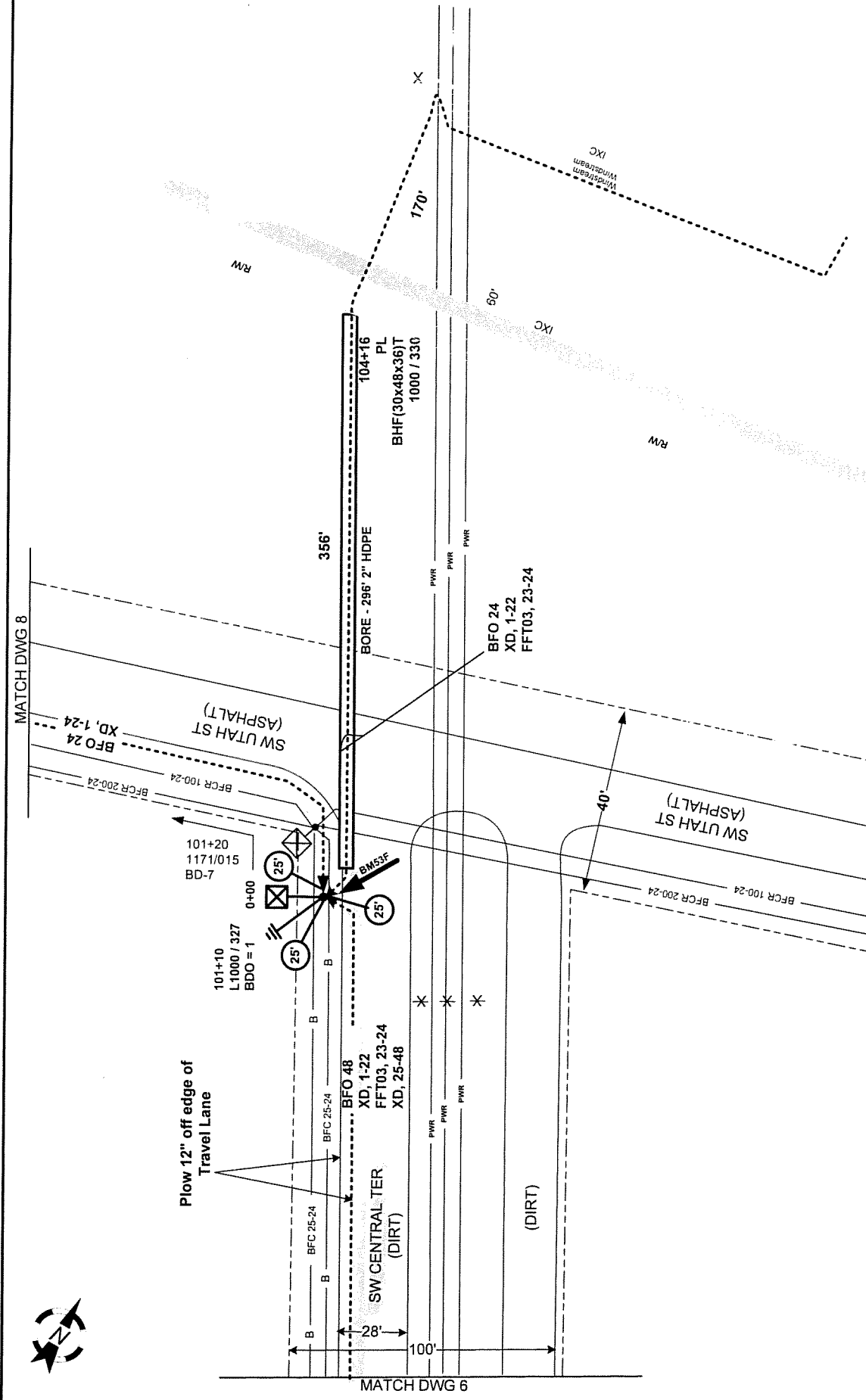

CONTACT NAMES AND NUMBERS:
 Florida OSP Eng. Manager: Gary Cary (office) 386-462-6530
 OSP Engineer: Mike Pickle (office) 407-835-0341

SEE TOWER
 DETAIL SHEET 10





This Drawing and Design are the sole property of Windstream and shall be considered Confidential. This Print may not be reproduced without written consent of Windstream.

CONSTRUCTION DRAWING
 RTE: 704752244
 Project: FB FTWH TM 91K0344B 12343 SW US Hwy 27
 District / Exchange: FORT WHITE, FL

Revision	1/2011
Rev #	00
Scale	AS SHOWN
Drawing	
Sheet	8
Total	

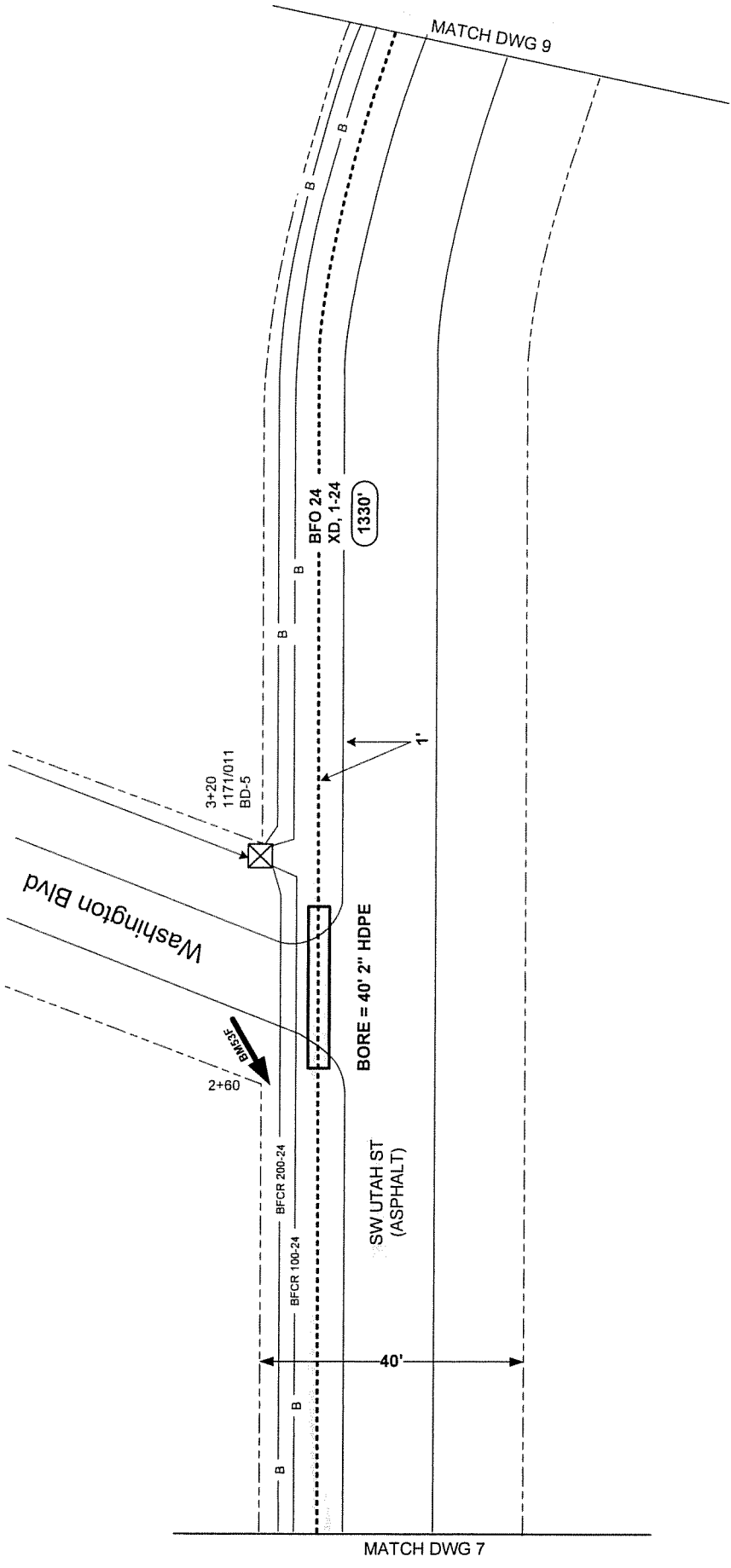

CONTACT NAMES AND NUMBERS:
 Florida OSP Eng. Manager: Gary Cary (office) 386-462-6530
 OSP Engineer: Mike Pickle (office) 407-835-0341



This Drawing and Design are the sole property of Windstream and shall be considered Confidential. This Print may not be reproduced without written consent of Windstream.

CONSTRUCTION DRAWING
 RTE 704752244
 Project: FB FTWH TM 9UN0344B 12343 SW US Hwy 27
 District / Exchange: FORT WHITE, FL

Drawn by: DMU	Sheet: 9
Rev: 00	Scale: N/A
WFA	Drawing
	Tab: 1

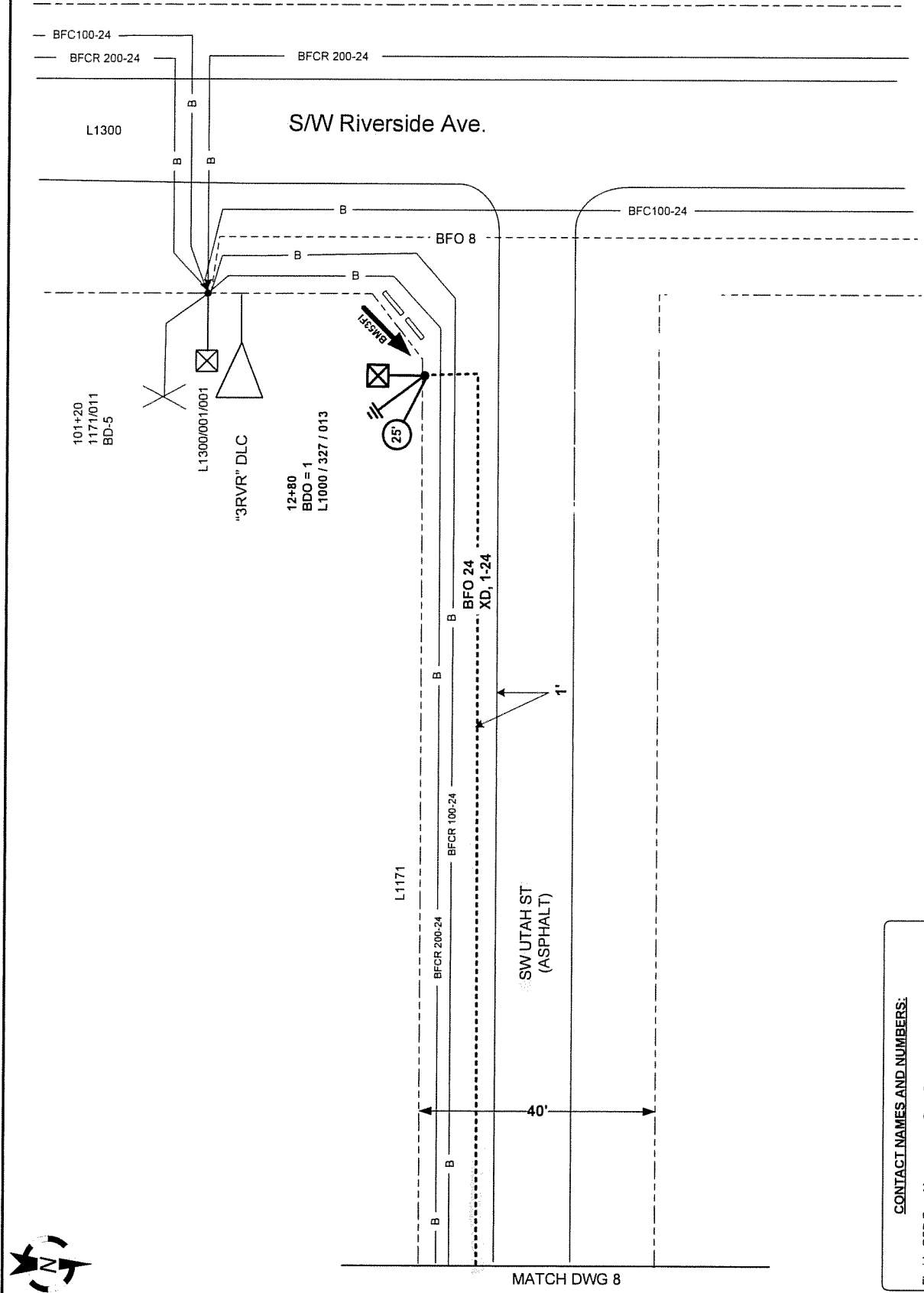

CONTACT NAMES AND NUMBERS:
 Florida OSP Eng. Manager: Gary Cary (office) 386-462-6530
 OSP Engineer: Mike Pickle (office) 407-835-0341